

BENTLEY MK. VISECTION EE N G I N E

Containing: -

GROUP	1	CONNECTING RODS AND PISTONS
	2	CRANKCASE
	3	CRANKSHAFT
	4	CYLINDER HEAD
	5	FLYWHEEL
	6	OIL PUMP AND RELIEF VALVE
	7	SPRING DRIVE
	8	VALVE MECHANISM
	9	WHEELCASE

KEY TO CHASSIS NUMBERS

Used on	A.B.C.D.E.F.G.H.J.	
" "	B-KM 2 - 200	
" "	B-KL 1 - 155, 179 - 197	
" "	B-LJ 2 - 24, 38	= F
" "	B-KL 157 - 177, 199 - 201	
" "	B-LJ 26 - 36 40 onwards	= G
Used up to	End of L Series	= H
Used on	M Series onwards	= J
" "	A & B Series	
" "	B-CF 2 - 500	
" "	B-CD 1-473, 479-489, 493-501	
" "	B-DA 2-6, 16, 118-126	= K
" "	B-CD 475-477, 491	
" "	B-DA 8-14, 18-116, 128 onwards	= L
" "	B-BH 132-138, 198 onwards	= M

Used on		A.B.C.D.E.F & G Series	=	P
Used on		A Series only	=	Q
Used on		B.C.D.E.F.		
" "	B-GT	1-309	=	R
Used on	B-GT	311-401		
" "		H.J.K & L Series	=	S
Used on		H Series onwards	=	T
Used on		H.J & K Series		
" "	B-LJ	2-298	=	U
Used on	B-LJ	300 onwards	=	V
Used on		A.B.C.D.E.F.G.		
" "	B-HR	2-50	=	W
Used on	B-HR	52 onwards	=	X
Used on		A.B.C.D.& E Series	=	Y
Used on	B-JN	87 & 193	=	Z
Used on		A & B Series		
" "	B-CF	2-500.		
" "	B-CD	1-453, 457, 459, 463-473, 479-481, 485, 493-499.	=	FF
Used on	B-CD	455, 461, 475, 477, 483, 487-491, 501.		
" "		D Series onwards	=	GG
Used on		A.B.C.D.E.F.G.H.J.K.L Series	=	HH
Used on		A & B Series		
" "	B-CF	2-24	=	JJ
Used on	B-CF	26-500.		
" "	B-CD	1-501.		
" "		D.E.F.G.H.J.K.& L Series	=	KK
Used on		A & B Series.		
" "	B-CF	2-216, 220-240, 244-254, 260-266, 270-274, 276, 282-298, 332, 348, 406, 408	=	LL
Used on	B-CF	218, 242, 256, 258, 268, 274, 278, 280, 300-330, 334-346, 350-404, 410-500.		
Used on	B-CD	1-473, 479-489, 493-501.		
" "	B-DA	2-6, 16, 118-126	=	MM
Used on	B-CD	475, 477, 491.		
" "	B-DA	8-14, 18-116, 128 onwards	=	NN

Used on	B-GT	273, 333, 341, 355, 367, 385 387, 395	
" "	B-HR	2-250	
" "	B-HP	1-251	
" "	B-JO	2-50, 54-100, 104-106, 110-128, 132-138, 142-162, 166-248	
" "	B-JN	1-17, 23, 25, 29-53, 57-61, 65-77, 85-115, 119-121, 125-131, 137-139, 145-147, 155, 169, 173, 177, 179, 183, 185, 191-207, 211-221, 225-227, 231-249	
" "	B-KM	2, 10, 12, 14, 20, 24, 28, 30, 36, 38, 46, 54, 56, 60, 62, 68, 76, 80, 84, 86, 92-104, 108, 110, 118, 138, 144, 148, 152, 156, 158, 162, 164, 176, 182, 186-198	
" "	B-KL	9, 17, 21, 25-27, 37, 47, 51, 55, 59, 65, 71, 73, 75, 77, 81, 83, 85, 105, 107, 109, 115, 183, 191.	
" "	B-LK	12, 70, 74-78, 186	= PF
Used on	B-JN	63, 81, 101, 135, 141, 149, 171, 181, 187, 189, 229, 233, 241, 247, 251.	
" "	B-KM	16, 26, 40, 42, 44, 50, 52, 66, 70, 72, 78, 82, 88, 90, 114, 116, 120-130, 136, 140, 142, 146, 150, 160, 166, 172, 174, 178, 184, 200,	
" "	B-KL	1, 11, 15, 23, 29, 33, 35, 39, 53, 57, 61, 63, 87, 89, 93, 101, 103, 123, 149, 155-159, 163	= QQ
Used on	B-JO	52, 108, 140, 164.	
" "	B-JN	19, 55, 79, 83, 117, 123, 133, 143, 153, 175, 209, 223, 235-239, 243, 245.	
" "	B-KM	4-8, 18, 22, 32, 34, 48, 58, 64, 74, 106, 112, 132, 134, 154, 168, 170, 180.	
Used on	B-KL	3-7, 31, 41, 43, 45, 49, 67, 69, 79, 91, 95, 97, 99, 111, 113, 117, 119, 121, 125-147, 151-153, 161, 165-181, 185-189, 193-201.	
" "	B-LJ	2-10, 14-68, 72, 80-184, 188-202, 204-400.	
" "	B-LH	1-401	= RR
Used on		A & B Series	
" "	B-CF	2-378, 382, 384, 406, 408, 424	= SS
Used on	B-CF	380, 386-404, 410-422, 426 on	= TT

Used on	B-CF	218, 242, 256, 258, 274, 278, 280, 300, -330, 334-346, 350-404, 410 onwards	= UU
Used on	B-BH	A Series 2-120	= VV
Used on	B-BH B-CF	122-400 2-378, 382-384, 406, 408, 424	= WW
Used on	B-JO	F.G.H. Series 2-50, 54-100, 104-106, 110-128, 132-138, 142-162, 166-248	
" "	B-JN	1-17, 23, 25, 29-53, 57-61, 65-77, 85, 89, 91, 93, 95, 97, 99, 101, 103-115, 119-121, 125-131, 137-139, 145, 147, 155-169, 173, 177-179, 183-185, 191, 193-207, 211-221, 225-227, 231, 249.	
" "	B-KM	2, 10-14, 20, 24, 28-30, 36, 38, 46, 54, 56, 60, 62, 68, 76, 80, 84-86, 92-104, 108-110, 118, 138, 144, 148, 152, 156-158, 162, 164, 176, 182, 186-198.	
" "	B-KL	9, 17-21, 25-27, 37, 47, 51, 55, 59, 65, 71-77, 81-85, 105-109, 115, 183 191.	
" "	B-LJ	12, 70, 74-78, 186	= XX
Used on	B-JO	A.B.C.D.E.F.G.H Series. 2-50, 54-100, 102-106, 110-128, 130-138, 142-162, 166-250	
" "	B-JN	1-17, 21-53, 57-61, 65-77, 85-115, 119-121, 125-131, 137-139, 145-147, 151, 155-169, 173, 177, 179, 183, 185, 191, 193-207, 211-221, 225-227, 231, 249.	
" "	B-KM	2, 10, 12, 14, 20, 24, 28, 30, 36, 38, 46, 54, 60, 62, 68, 76, 80, 84, 86, 92-104, 108, 110, 118, 138, 144, 148, 152, 156, 158, 162, 164, 176, 182, 186-198.	
" "	B-KL	17-21, 25-27, 37, 47, 51, 55, 59, 65, 71, 73, 75, 77, 81, 83, 85, 105, 107, 109, 115, 183, 191.	
" "	B-LJ	12, 70, 74-78, 186	= YY
Used on	B-EY	A.B.C.D. Series 2-500	
" "	B-EW	1-151, 155, 157, 173, 181-191, 195, 203	= ZZ
Used on	B-EW	153, 159-171, 175-179, 193, 197-201, 205 onwards	= FFF
Used on		F Series onwards	= HHH

Used on	B-GT	273, 333, 341, 355, 367, 385, 387, 395.	
" "	B-HR	2-250.	
" "	B-HP	1-251.	
" "	B-JO	2-50, 54-100, 104-106, 110-128, 132-138, 142-162, 166-248.	
" "	B-JN	1-17, 23, 25, 29-53, 57-77, 81, 85-115, 119-121, 125-131, 135-141, 145-149, 155-173, 177-207, 211-221, 225-233, 241, 247-251.	
Used on	B-KM	2, 10, 12, 14, 16, 20, 24-30, 36-46, 50-56, 60, 62, 66-72, 76-104, 108, 110, 114, 116-130, 136-152, 156-166, 172-178, 182-200.	
" "	B-KL	1, 9-29, 38-39, 47, 51-65, 71-77, 81-89, 93, 101-109, 115, 123, 149, 155, 157, 159, 163, 183, 191.	
" "	B-LJ	12, 70, 74-78, 186	= JJJ
Used on	B-JO	52, 108, 140, 164.	
" "	B-JN	19, 55, 79, 83, 117, 123, 133, 143, 153, 175, 209, 223, 235-239, 243, 245.	
" "	B-KM	4, 6, 8, 18, 22, 32, 34, 48, 58, 64, 74, 106, 112, 132, 134, 154, 168, 170, 180.	
" "	B-KL	3-7, 31, 41, 43, 45, 49, 67, 69, 79, 91, 95, 97, 99, 111, 113, 117, 119, 121, 125-147, 151, 153, 161, 165-181, 185-189, 193-201	= KKK
Used on		A.B.C. Series.	
" "	B-DA	2-472, 478-494, 500.	
" "	B-DZ	25-31, 35, 49, 93	= LLL
Used on	B-DA	474, 476, 496, 498.	
" "	B-DZ	1-23, 33, 37-47, 51-91, 95-501. E.F.G.H.J.K.L Series.	= MMM
Used on	B-MD	146, 162, 174, 178, 192, 214, 220, 224, 226, 236, 240, 270, 286, 386.	
" "	B-MB	141	= NNN
Used on	B-MD	2-144, 148-160, 164-172, 176, 180-190, 194-212, 216-218, 222, 228-234, 238, 242-268, 272-284, 288-384, 388-500.	
" "	B-MB	1-139, 143 onwards	= OOO
Used on		F Series.	
" "	B-GT	1-271, 275-331, 335-339, 343-353, 357-365, 369-383, 389-393, 397-401.	
" "	B-JO	102, 130, 250.	
" "	B-JN	21, 27, 151.	= PPP

Used on	B-GT	273, 333, 341, 355, 367, 387, 395,	
" "		All H Series.	
" "	B-JO	2-100, 104-128, 132-248.	
" "	B-JN	1-19, 23, 25, 29-149, 153-251.	
		K Series onwards	= QQQ
Used on	B-JO	52, 108, 140, 164.	
" "	B-JN	19, 55, 63, 79-83, 101, 117, 123,	
		133, 135, 141, 143, 149, 153, 171,	
		175, 181, 187, 189, 209, 223, 229,	
		233-247, 251.	
" "	B-KM	4-8, 16, 18, 22, 26, 32, 34, 40-44,	
		48-52, 58, 64, 66, 70-74, 78, 82, 88,	
		90, 112-116, 120-136, 140, 142, 146,	
		150, 154, 160, 166-174, 178, 180,	
		184, 200.	
" "	B-KL	1-7, 11, 15, 23, 29-35, 39-45, 49, 53,	
		57, 61, 63, 67, 69, 79, 87, 89, 91-103,	
		111, 113, 117-181, 185-189, 193-201.	
" "	B-LJ	2-10, 14-68, 72, 80-184, 188-202,	
		204-400.	
" "	B-LH	1-401	= SSS
Used on	B-GT	273, 333, 341, 355, 367, 385, 387,	
" "		395.	
" "		H Series.	
" "	B-JO	2-100, 104-128, 132-248.	
" "	B-JN	1-19, 23, 25, 29-149, 153-251.	
" "		K Series onwards	= TTT

GROUP E1. CONNECTING RODS & PISTONS

Comprising:

BUSH, connecting rod, large end pair of	1	RE.3236	6	
BUSH, connecting rod, large end pair of .005" u/s		RE.4850	-	
BUSH, connecting rod, large end pair of .010" u/s		RE.9906	-	
BUSH, connecting rod, small end pair of	2	EB.5211	6	
PIN, split, connecting rod bolt	3	E.84689	12	
PISTON, assembly consisting of:	4	See Below	6	
Pin, gudgeon with caps		RE.3901	1	H
Pin, gudgeon with caps		RE.11304	-	J
Ring, second 'L' Section		See Below	1	
Ring, top, plain Section		See Below	1	
Ring, scraper		See Below		
ROD, connecting, connecting assembly consisting of:	5	RE. 9649	6	
Bolt,		EB. 2701	2	
Bolt, .004" c/s on shank dia.,		RE. 4835	-	
Bolt, .002" c/s on shank dia.,		RE.13832	-	
Cap,		RE. 9439	1	
Cap, .004" c/s on bolt holes		RE. 4834	-	
Cap, .002" c/s on bolt holes		RE.13827	-	
Nut,		EB.2220	-	
Rod,		RE. 9438	6	
Rod, .004" c/s on bolt holes		RE. 4833	-	
Rod, .002" c/s on bolt holes		RE.13826	-	

PISTON DETAILS

Size.	Piston Assembly.	Piston.	Compression Ring.	Centre.	Scraper Ring.		
Standard	RE.13784	RE.13617	RE.11063	RE.12564	RE.12565	} H	
.005	RE.13785	RE.13775	RE.11144	RE.13922	RE.13841		
.010	RE.13786	RE.13776	RE.11145	RE.13923	RE.13842		
.015	RE.13787	RE.13777	RE.11146	RE.13924	RE.13843		
.020	RE.13788	RE.13778	RE.11147	RE.13925	RE.13844		
.025	RE.13789	RE.13779	RE.11148	RE.13926	RE.13845		
.030	RE.13790	RE.13780	RE.11149	RE.13927	RE.13846		
.035	RE.13791	RE.13781	RE.11150	RE.13928	RE.13847		
.040	RE.13792	RE.13782	RE.11151	RE.13929	RE.13848		
.045	RE.13793	RE.13783	RE.11152	RE.13930	RE.13849		
Standard	RE.14773	RE.14761	RE.15787	RE.15788	RE.13605		} J
.005	RE.15789	RE.15778	RE.15798	RE.15807	RE.13766		
.010	RE.15790	RE.15779	RE.15799	RE.15808	RE.13767		
.015	RE.15791	RE.15780	RE.15800	RE.15809	RE.13768		
.020	RE.15792	RE.15781	RE.15801	RE.15810	RE.13769		
.025	RE.15793	RE.15782	RE.15802	RE.15811	RE.13770		
.030	RE.15794	RE.15783	RE.15803	RE.15812	RE.13771		
.035	RE.15795	RE.15784	RE.15804	RE.15813	RE.13772		
.040	RE.15796	RE.15785	RE.15805	RE.15814	RE.13773		
.045	RE.15797	RE.15786	RE.15806	RE.15815	RE.13774		

GROUP E2. CRANKCASE.

Comprising:

ADAPTOR, crankcase oil feed	1	RE. 9423	1	PP
ADAPTOR, crankcase oil feed assembly consisting of:	2	RE. 13850A	1	QQ
Casing		RE. 13850	1	
Plug, core top	X.26	KB. 7304	1	
Plug, core bottom	X.26	KB. 7301	1	
Washer, joint, core plug	X.83	KB. 1089	1	
Washer, joint, core plug	X.83	KB. 1081	1	
ADAPTOR, crankcase, oil feed, as above except casing		RE. 13873A	1	RR
ADAPTOR, crankcase, oil feed consisting of:	3	RE. 13894A	1	J
Casing		RE. 13894	1	
Plug, core	X.26	KB. 7304	1	
Plug, screwed	X.26	RE. 13938	1	
Washer, core plug	X.83	KB. 1089	1	
Washer, screw plug	X.83	KB. 1078	1	
ADAPTOR, coolant pump to crankcase assembly with stud KB.409 4 off	4	RE. 7484	1	
ADAPTOR, cylinder drain tap.	5	RE. 4808	1	
ARM, swivel, dynamo belt adjusting	6	RE. 491	1	SS
ARM, swivel, dynamo belt adjusting		RE. 13825	1	TT
BAFFLE, oil crankcase lower half	7	EB. 4063	1	
BOLT, .250" dia., wheelcase retaining	X.10	K. 209/Z	2	
BOLT, .312" dia., downtake, exhaust pipe to stay	X.11	K. 345/Z	1	H
BOLT, .312" dia., dynamo belt swivel arm (connection to pump backing plate)	X. 5	KB. 8551	1	
BOLT, .312" dia., dynamo to bracket front	X. 5	KB. 2805/Z	1	SS
BOLT, .312" dia., dynamo to bracket rear	X. 5	KB. 2809/Z	1	SS
BOLT, .312" dia., dynamo to bracket front and rear	X. 5	KB. 8559/Z	2	TT
BOLT, .312" dia., fitting wheelcase		RE. 13425	1	UU
BOLT, .312" dia., fitting wheelcase		RE. 13424	2	UU
BRACKET, dynamo assembly	8	RE. 3498	1	VV
BRACKET, dynamo assembly		RE. 6374	1	WW
BRACKET, dynamo assembly		RE. 5492	1	TT
BRACKET, support, twin exhaust system (R.C)		RE. 5500	1	J
BRACKET, fuel pipe (R.C)	9	RE. 9290	1	
BRACKET, fuel pipe (L.C)		RE. 9290	1	J
BREATHER, crankcase assembly, consisting of (when crankcase breather is fitted:-		EB. 5020A	1	
Body		EB. 5020	1	
Pin, taper, .187" dia.,	X.32	K. 4819	1	
Pipe		EB. 5021	1	
BUSH, camshaft, bearing front	10	RE. 210	1	
BUSH, camshaft, bearing, intermediate	11	RE. 3892	2	
BUSH, camshaft, bearing, rear	12	EB. 4146	1	

GROUP E2. (Continued Overleaf)

GROUP E2. CRANKCASE. (Continued)

BUSH, crankshaft, centre lower half	13		
Standard size		RE. 3241	1
.005" u/s in bore		RE. 4845	-
.010" u/s in bore		RE. 9913	-
.020" u/s in bore		RE. 15125	-
.030" u/s in bore		RE. 15133	-
.040" u/s in bore		RE. 15141	-
.060" u/s in bore		RE. 15149	-
BUSH, crankshaft, centre upper half	14		
Standard size		RE. 3240	1
.005" u/s in bore		RE. 4844	-
.010" u/s in bore		RE. 9912	-
.020" u/s in bore		RE. 15124	-
.030" u/s in bore		RE. 15132	-
.040" u/s in bore		RE. 15140	-
.060" u/s in bore		RE. 15148	-
BUSH, crankshaft, front lower half	15		
Standard size		RE. 3245	1 H
.005" u/s in bore		RE. 4849	-
.010" u/s in bore		RE. 9917	-
.020" u/s in bore		RE. 15129	-
.030" u/s in bore		RE. 15137	-
.040" u/s in bore		RE. 15145	-
.060" u/s in bore		RE. 15153	-
BUSH, crankshaft, front lower half			
Standard size		RE. 12852	1 J
.005" u/s in bore		RE. 15988	1
.010" u/s in bore		RE. 15906	-
.020" u/s in bore		RE. 15910	-
.030" u/s in bore		RE. 15914	-
.040" u/s in bore		RE. 15918	-
.060" u/s in bore		RE. 15922	-
BUSH, crankshaft, front upper half	16		
Standard size		RE. 3244	1 H
.005" u/s in bore		RE. 4848	-
.010" u/s in bore		RE. 9916	-
.020" u/s in bore		RE. 15128	-
.030" u/s in bore		RE. 15136	-
.040" u/s in bore		RE. 15144	-
.060" u/s in bore		RE. 15152	-

GROUP E2. (Continued Overleaf)

GROUP E2. CRANKCASE. (Continued)

BUSH, crankshaft, front upper half

Standard size	RE. 12851	1	J
.005" u/s in bore	RE. 15987	1	
.010" u/s in bore	RE. 15905	-	
.020" u/s in bore	RE. 15909	-	
.030" u/s in bore	RE. 15913	-	
.040" u/s in bore	RE. 15917	-	
.060" u/s in bore	RE. 15921	-	

BUSH, crankshaft, intermediate, lower half 17

Standard size	RE. 3243	4	
.005" u/s in bore	RE. 4847	-	
.010" u/s in bore	RE. 9915	-	
.020" u/s in bore	RE. 15127	-	
.030" u/s in bore	RE. 15135	-	
.040" u/s in bore	RE. 15143	-	
.060" u/s in bore	RE. 15151	-	

BUSH, crankshaft, intermediate, upper half 18

Standard size	RE. 3242	4	
.005" u/s in bore	RE. 4846	-	
.010" u/s in bore	RE. 9914	-	
.020" u/s in bore	RE. 15126	-	
.030" u/s in bore	RE. 15134	-	
.040" u/s in bore	RE. 15142	-	
.060" u/s in bore	RE. 15150	-	

BUSH, crankshaft, rear, lower half 19

Standard size	RE. 3239	1	H
.005" u/s in bore	RE. 4843	-	
.010" u/s in bore	RE. 9911	-	
.020" u/s in bore	RE. 15123	-	
.030" u/s in bore	RE. 15131	-	
.040" u/s in bore	RE. 15139	-	
.060" u/s in bore	RE. 15147	-	

BUSH, crankshaft, rear lower half

Standard size	RE. 12854	1	J
.005" u/s in bore	RE. 15990	1	
.010" u/s in bore	RE. 15908	-	
.020" u/s in bore	RE. 15912	-	
.030" u/s in bore	RE. 15916	-	
.040" u/s in bore	RE. 15920	-	
.060" u/s in bore	RE. 15924	-	

GROUP E2. (Continued Overleaf)

GROUP E2. CRANKCASE. (Continued)

BUSH, crankshaft, rear upper half

20

Standard size	RE. 3238	1	H
.005" u/s in bore	RE. 4842	-	
.010" u/s in bore	RE. 9910	-	
.020" u/s in bore	RE. 15122	-	
.030" u/s in bore	RE. 15130	-	
.040" u/s in bore	RE. 15138	-	
.060" u/s in bore	RE. 15146	-	

BUSH, crankshaft, rear upper half

Standard size	RE. 12853	-	J
.005" u/s in bore	RE. 15989	-	
.010" u/s in bore	RE. 15907	-	
.020" u/s in bore	RE. 15911	-	
.030" u/s in bore	RE. 15915	-	
.040" u/s in bore	RE. 15919	-	
.060" u/s in bore	RE. 15923	-	

CLIP, breather to crankcase (when rocker
cover breather is fitted)

21 RE. 5467 1

CONNECTION, swivel plug, pressure gauge
connection

22 RE. 2639 1 Y

CONNECTION, swivel plug, pressure gauge
connection

RE. 5721 1 XX

CONNECTION, swivel plug, pressure gauge
connection

RE. 13884 1 Z

CONNECTION, external type distributor oil feed

RE. 4036 1 Y

CONNECTION, oil gallery rear (to distributor
oil feed)

RE. 3481 1 Y

CONNECTION, banjo pressure gauge

RE. 4830 1 YY

CONNECTION, rocker oil feed

23 E. 85380 1

COVER, blanking, breather face (when
crankcase breather is not fitted)

24 RE. 5466 1

COVER, rear, camshaft bearing

25 RE. 4147 1

COVER, tappet (Steel)

26 RE. 798 2

COVER, tappet (aluminium)

RE. 5187 2

CRANKCASE, lower half assembly without
locating dowels, consisting of:

27 RE. 3671 1 ZZ

Adaptor

KB. 6107/Z 2

Stud, 2 BA, oil baffle

X.62 KB. 299/Z 4

CRANKCASE, lower half assembly as above but
with locating dowels RE. 10416

RE. 10417 1 FFF

CRANKCASE, upper half assembly, consisting of:

28 RE. 8812 1 HH

Cap, main bearing, centre

RE. 4026 1

Cap, main bearing, front

RE. 185 1 HH

Cap, main bearing, intermediate

RE. 186 4

Cap, main bearing, rear assembly consisting of:

RE. 9512 1 HH

Cap

RE. 3930 1

Disc, expanding

RE. 3328 1

GROUP E2. (Continued Overleaf)

GROUP E2. CRANKCASE. (Continued)

CRANKCASE, upper half assembly, consisting of:

(Continued)

Cover, coolant, jacket (2 off only, are used on early chassis core plug being used on centre L.H. face)		EW.1431	3	
Cover, coolant, jacket (L.C.)		EW.1431	2	
Cover, coolant, jacket (L.C.)		RE.8257	1	
Cover, rear, coolant, jacket (L.C.)		RE.4910	1	
Gallery, coolant, with cap RE.12889		RE.12889	1	HH
Guide, valve, exhaust (cast iron non-flanged) or		EB.4425	6	
Guide, valve, exhaust (bronze flanged)		RE.5890	6	
Insert, cylinder bore (where fitted)		RE.6017	6	HH
Insert, distributor oil feed		RE.3634	1	Y
Joint, coolant jacket cover		RE.4864	3	
Joint, rear coolant jacket cover		RE.4911	1	
Nut, full, .375" dia., main bearing caps	X.21	K.4010/Z	14	
Plug, core hole, coolant pump facing		RE.9016	1	
Plug, core hole, oil gallery front and rear	X.26	KB.7303	2	
Plug, core hole, oil gallery (distributor feed)	X.26	KB.7303	1	HHH
Plug, core hole, coolant jacket (fitted on early chassis when 2 off only EW.1431 are fitted)	X.26	KB.7303	1	
Plug, core hole tappet chamber		RE.4782	2	
SCREW, counter sunk head, 2 BA, coolant jacket cover (2 off on early chassis where 2 only EW.1431 cover are fitted)	X.50	K.2804/Z	26	Y
SCREW, counter sunk head 2 BA, coolant jacket cover	X.50	K.2804/Z	27	HHH
Stud, adaptor casing	X.68	KB.352/Z	4	JJJ
Stud, adaptor casing	X.66	KB.361/Z	4	KKK
Stud, adaptor casing	X.66	KB.359/Z	4	J
Stud, breather, pipe clip (when rocker cover breather is fitted)	X.65	KB.3826/Z	1	
Stud, flanged, tappet cover		RE.329	4	
Stud, 2 BA, fuel pipe bracket (R.C.)	X.61	KB.650/Z	2	HH
Stud, 2 BA, fuel drain pipe clip (L.C.)	X.61	KB.650/Z	1	HH
Stud, 2 BA, oil pressure relief valve retaining	X.61	KB.660/Z	3	
Stud, 2 BA, water jacket cover (distributor oil feed pipe clip)	X.63	KB.252/Z	1	Y
Stud, 2 BA, oil baffle	X.63	KB.299/Z	4	
Stud, .250" dia., camshaft thrust plate retaining	X.66	KB.750/Z	3	
Stud, .250" dia., wheelcase	X.66	KB.751/Z	9	LL
Stud, .250" dia., wheelcase	X.66	KB.751/Z	6	MM
Stud, .250" dia., retaining breather	X.66	KB.751/Z	2	
Stud, .250" dia., distributor housing retaining	X.66	KB.764/Z	2	
Stud, .250" dia., exhaust manifold	X.68	KB.359	12	
Stud, .250" dia., dynamo bracket	X.66	KB.751/Z	2	VV
Stud, .250" dia., dynamo bracket	X.66	KB.754/Z	2	VV

GROUP E2. (Continued Overleaf)

GROUP E2. CRANKCASE. (Continued)

CRANKCASE, upper half assembly, consisting of:
(continued)

Stud, .312" dia., dynamo bracket	X.73	KB. 403/Z	2	WW
Stud, .312" dia., dynamo bracket	X.73	KB. 400/Z	2	WW
Stud, .312" dia., dynamo bracket	X.73	KB. 400/Z	4	TT
Stud, .312" dia., front face engine mounting	X.71	KB. 820/Z	3	
Stud, .312" dia., coolant pump adaptor retaining	X.71	KB. 802/Z	5	
Stud, .312" dia., oil filter retaining	X.71	KB. 800/Z	2	HH
Stud, .312" dia., oil pump retaining	X.71	KB. 804/Z	1	
Stud, .312" dia., cylinder head long		RE. 7955	9	LLL
Stud, .375" dia., cylinder head long		RE. 7566	9	MMM
Stud, .312" dia., cylinder head short		RE. 7954	30	LLL
Stud, .275" dia., cylinder head short		RE. 7567	30	MMM
Stud, .375" dia., main bearing cap retaining	X.76	KB. 469/Z	14	HH
Washer, aluminium, .750" core plug oil gallery front and rear	X.83	KB. 1082	2	
Washer, aluminium, .750" dia., insert RE.3634	X.83	KB. 1091	1	Y
Washer, aluminium, 1.00" dia., core plug tappet chamber	X.83	KB. 1092	2	
Washer, lock bearing cap	X.89	KB. 7108	14	
CRANKCASE, upper half assembly as above except:		RE.13404	1	NNN
Cap, main bearing rear		RE.13836	1	
Cap, main bearing front		RE.12877	1	
Gallery, coolant, with cap RE.10473		RE.10475	1	
Insert, cylinder block		RE.10967	1	
Plug, core hole, between 3 & 4 and 5 & 6 exhaust parts	X.26	KB. 7301	2	
Plug, core, hole end faces		RE.16302	2	
Stud, adaptor, casing, to crankcase	X.68	KB. 359/Z	4	
Stud, oil filter mounting plate to crankcase top	X.66	KB. 751/Z	1	
Stud, oil filter mounting plate to crankcase lower	X.71	KB. 800/Z	2	
Stud, cylinder head long		RE.10427	9	
Stud, cylinder head short		RE.10425	30	
Stud, 2 BA, fuel pipe bracket (R.C & L.C)	X.61	KB. 650/Z	2	
Stud, main bearing cap		RE.14982	14	
CRANKCASE upper half assembly as above except:		RE.13835	1	000
Stud, oil filter mounting plate to crankcase	X.71	KB. 800/Z	4	
DIPSTICK, oil level assembly	29	RE. 4783	1	
DOWEL, clutch casing	30	RE. 319	2	
DOWEL, cylinder head centre	31	E. 50362	1	
DOWEL, cylinder head rear	32	E. 50363	1	HH
DOWEL, wheelcase	33	RE. 3475	2	LL
HOUSING, distributor, assembly with .250" dia., stud, KB. 352/Z 1 off	34	RE. 9829		
JET, internal type, distributor oil feed		RE.12404	1	PPP
JET, internal type, distributor oil feed		RE.14428	1	QQQ

GROUP E2. (Continued Overleaf)

GROUP E2. CRANKCASE. (Continued)

JOINT, breather to crankcase or blanking cover to crankcase	35	EB. 4055	1	
JOINT, coolant pump adaptor to crankcase	36	EB. 4219	1	
JOINT, coolant pump to adaptor	37	RE. 5772	1	
JOINT, full flow filter adaptor to crankcase	38	RE. 9425	1	QQQ
JOINT, tappet cover (steel)	39	EB. 4059	2	
JOINT, tappet cover (aluminium)		RE. 5427	2	
JOINT, cylinder head to crankcase	40	RE. 7878	1	H
JOINT, cylinder head to crankcase		RE. 10478	1	J
JOINT, distributor housing to crankcase	41	EB. 4042	1	
JOINT, exhaust manifold to crankcase	42	EB. 4039	6	
JOINT, oil relief valve to crankcase	43	EB. 3953	1	
JOINT, rear camshaft bearing cover	44	EB. 4179	1	
JOINT, upper to lower crankcase	45	RE. 10419	1	
JOINT, wheelcase to crankcase (dowel type)	46	RE. 3474	1	LL
JOINT, wheelcase to crankcase (fitting bolt type)		RE. 6341	1	UU
NUT, full, 2 BA, fuel pipe bracket (R.C)	X.21	K. 4006/Z	2	HH
NUT, full, 2 BA, fuel pipe bracket (R.C & L.C)	X.21	K. 4006/Z	2	J
NUT, full, 2 BA, oil baffle	X.21	K. 4006/Z	4	
NUT, full, 2 BA, oil relief valve	X.21	K. 4006/Z	3	
NUT, full, 2 BA, fuel drain pipe clip (L.C)	X.21	K. 4006/Z	1	HH
NUT, full, 2 BA, oil pipe external oil feed to distributor	X.24	K. 4307/Z	1	Y
NUT, .250" dia., exhaust manifold retaining	47	EW. 1833	12	
NUT, full, cylinder head to crankcase (.312" dia.)	48	RE. 7956	39	LLL
NUT, full, cylinder head to crankcase (.375" dia.)	X.21	K. 4010/Z	39	MMM/J
NUT, full, .312" dia., dynamo belt, swivel arm and front & rear bracket bolts (dynamo bolt & nut to swivel arm supplied by Lucas)	X.21	K. 4009/Z	3	SS
NUT, full, .312" dia., engine mounting stud front face	X.21	K. 4009/Z	3	
NUT, full, .312" dia., oil filter	X.21	K. 4009/Z	2	H
NUT, full, .312" dia., oil pump stud	X.21	K. 4009/Z	1	
NUT, full, .312" dia., dynamo to bracket (when 4.5" dynamo is fitted)	X.21	K. 4009/Z	1	SS
NUT, half, 2 BA, fuel drain pipe clip (L.C)	X.24	K. 4307/Z	1	H
NUT, adaptor, casing, (when full flow filter adaptor is fitted with bye-pass filter)	X.21	K. 4008/Z	4	
NUT, adaptor, casing (when full flow filter is fitted)	X.24	K. 4310/Z	4	J
NUT, half, .250" dia., filter mounting plate top	X.24	K. 4310/Z	1	NNN
NUT, half, .250" dia., breather to crankcase or cover plate to crankcase	X.24	K. 4310/Z	2	
NUT, half, .250" dia., camshaft thrust plate	X.24	K. 4310/Z	3	
NUT, half, .250" dia., distributor clamping and housing stud	X.24	K. 4310/Z	3	
NUT, half, .250" dia., breather clip (when rocker cover breather is fitted)	X.24	K. 4310/Z	2	
NUT, half, .250" dia., wheelcase stud and bolt	X.24	K. 4310/Z	11	LL
NUT, half, .250" dia., wheelcase stud and bolt	X.24	K. 4310/Z	8	MM/NN
NUT, half, .250" dia., dynamo bracket	X.21	K. 4008/Z	4	VV
NUT, half, .312" dia., coolant pump adaptor	X.24	K. 4313/Z	5	
NUT, half, .312" dia., coolant pump to adaptor	X.24	K. 4313/Z	4	

GROUP E.2. (Continued Overleaf)

GROUP E2. CRANKCASE. (Continued)

NUT, half, .312" dia., downtake exhaust stay bolt (R.C)	X.24	K.431 3/2	1	
NUT, half, .312" dia., downtake exhaust stay bolt (L.C)		K.431 3/2	1	H
NUT, half, .312" dia., dynamo to bracket and swivel arm	X.24	K.431 3/2	3	TT/WW
NUT, half, .312" dia., dynamo bracket stud	X.24	K.431 3/2	4	WW
NUT, half, .312" dia., wheelcase fitting bolts	X.24	K.431 3/2	3	MM
NUT, half, .312" dia., filter mounting plate bottom	X.24	K.431 3/2	2	NNN
NUT, half, .312" dia., filter mounting plate	X.24	K.431 3/2	4	OOO
NUT, sleeve tappet cover retaining (for aluminium cover)	49	RE.5189	4	
NUT, sleeve, tappet cover retaining (for steel covers)		RE. 218	4	
NUT, reach cylinder head		RE.11531	2	J
PIECE, distance, downtake support exhaust (LC)		RF. 513	1	
PIECE, distance, dynamo bracket		RE.3495	1	VV/WW
PIECE, distance, tappet cover (steel type)		RE. 322	4	
PIECE, distance, mounting full flow filter		RE.13939	1	NNN
PIN, taper relief Valve, over flow pipe retaining	X.32	K. 4846/2	1	
PIPE, cylinder, drain assembly	50	RE. 4809	1	
PIPE, oil relief valve over flow	51	EB. 4041	1	
PIPE, oil return, rear bearing cap	52	EB. 4032	1	
PLATE, camshaft thrust	53	RE. 142	1	
PLUG, core, adaptor casing	X.26	KB.7304	1	J
PLUG, oil drain, lower half crankcase	54	RE. 3744	1	
PLUG, screw, adaptor casing	55	RE.13938	1	J
PLUG, screw, petrol pipe bracket facing	X.54	KC. 150/2	2	H
SCREW, cheese head, 3BA, oil level unit	X.45	K. 1807/2	6	
SCREW, counter sunk head, 2 BA, rear camshaft bearing cover	X.50	K. 2810/2	4	
SCREW, hex head, .250" dia., distributor	55A	RE.3559	1	
SCREW, hex head, .250" dia., wheelcase facing	X.55	KC.231/2	2	
SCREW, hex head, .312" dia., lower half crankcase	X.56	KC.281/2	17	
SCREW, hex head, .312" dia., lower half crankcase, drain pipe clip & exhaust pipe stay	X.56	KC.282/2	3	
SCREW, hex head, .437" dia., clutch casing	X.58	KC.358/2	2	
SCREW, set, filter to mounting plate	X.56	KC.277/2	2	J
SCREW, set, oil feed pipe flange crankcase	X.55	KC.231/2	2	
SCREW, sealing, water jacket Nos. 2 & 5 cylinders	X.55	KC. 901	2	
SEAL, oil, rear, crankshaft bearing	56	RE. 7144	2	
SHAFT, driving, distributor, assembly with dog RE.4921	57	RE.4920	1	
STAY, exhaust, downtake support (L.C)		RF.8310	1	
STAY, exhaust, downtake support (L.C)		RF.8311	1	
STAY, downtake, exhaust pipe front short (R.C)	58	RE.4675	1	HH
STAY, downtake, exhaust pipe front long	59	RE.4676	1	HH
TAP, drain cylinder	60	RE.5150	1	

GROUP E2 (Continued Overleaf)

GROUP E2. CRANKCASE. (Continued)

UNIT, oil level recording, with washer	61	DB. 1870	1	
UNION, oil pipe, by-pass filter to crankcase adaptor	62	RE. 9918	1	PP
UNION, oil pipe, by-pass filter to crankcase adaptor		KB. 3042/Z	1	SSS
UNION, adaptor casing	63	RE. 6240	2	J
UNION, oil pressure gauge pipe	X. 9	KB. 5101/Z	1	SSS/J
WASHER, aluminium, .830" dia., coolant jacket drain tap	X.83	KB. 1098	1	
WASHER, aluminium, 1.000" dia., oil drain plug	X.83	KB. 1084	1	
WASHER, aluminium, swivel plug, rocker oil feed	64	RE. 3523	2	
WASHER, aluminium, external type distributor oil feed		RE. 3523	1	Y
WASHER, aluminium, petrol pipe, bracket fascia (L.C)	X.83	KB. 1075	2	HH
WASHER, aluminium, oil gallery connection		RE. 3523	2	Y
WASHER, aluminium, oil pressure gauge connection	65	RF. 3274	2	Y/PPP/SSS/J
WASHER, aluminium, sealing tappet cover nut		RF. 3274	4	
WASHER, C& A, cylinder drain tap	66	RE. 4787	1	
WASHER, joint, pressure gauge union on adaptor	X.83	KB. 1096	1	Y/PPP/SSS/J
WASHER, locking, oil feed pipe (2) and thrust plate (3)	X.89	KB. 7106	5	
WASHER, locking, dynamo bolt	X.89	KB. 7107	2	TT
WASHER, locking, oil pump	X.89	KB. 7107	1	
WASHER, locking, oil baffle	X.89	KB. 7104	4	
WASHER, plug, adaptor casing	X.83	KB. 1089	1	J
WASHER, plain, exhaust manifold studs	X.85	K. 4407/Z	12	
WASHER, plain, breather (where rocker cover breather is fitted)	X.85	K. 4407/Z	2	
WASHER, plain, filter to mounting plate	X.85	K. 4407/Z	2	J
WASHER, plain, .312" dia., downtake stay	X.84	KB. 3906/Z	1	HH
WASHER, plain, bolt, swivel arm (dynamo) to backplate	X.84	KB. 3906/Z	1	TT
WASHER, plain, .312" dia., dynamo bolt	X.86	K. 8807/Z	4	TT
WASHER, plain, .312" dia., cylinder head, to crankcase	X.85	K. 4410/Z	39	LLL
WASHER, plain, .312" dia., filter mounting plate	X.85	K. 4410/Z	4	OOO
WASHER, plain, .312" dia., filter mounting plate	X.85	K. 4410/Z	2	NNN
WASHER, plain, .375" dia., cylinder head to crankcase	X.85	K. 4413/Z	39	MMM/J
WASHER, screw plug, adaptor casing	X.83	KB. 1078	1	J
WASHER, spring, 3 BA, sump, oil level unit screw	X.87	K. 9005/Z	6	
WASHER, spring, 2 BA, petrol drain pipe clip (L.C)	X.87	K. 9006/Z	1	HH
WASHER, spring, 2 BA, oil relief valve stud	X.87	K. 9006/Z	3	
WASHER, spring, 2 BA, oil pipe internal oil feed to distributor	X.87	K. 9006/Z	1	Y

GROUP E2. (Continued Overleaf)

GROUP E2. CRANKCASE. (Continued)

WASHER, spring, 2 BA, petrol pipe bracket (R.C)	X.87	K. 9006/Z	2	HH
WASHER, spring, 2 BA, petrol pipe bracket (R.C & L.C)	X.87	K. 9006/Z	2	J
WASHER, spring, .250" dia., dynamo mounting bracket	X.87	K. 9008/Z	4	VV
WASHER, spring, .250" dia., distributor clamping housing studs and retaining screw	X.87	K. 9008/Z	4	
WASHER, spring, .250" dia., breather or breather blanking cover	X.87	K. 9008/Z	2	
WASHER, spring, .250" dia., breather pipe clip, (when rocker cover breather is fitted)	X.87	K. 9008/Z	1	
WASHER, spring, .250" dia., wheelcase facing stud, screw and bolt	X.87	K. 9008/Z	13	LL
WASHER, spring, .250" dia., wheelcase facing stud, screw and bolt	X.87	K. 9008/Z	10	MM/NN
WASHER, spring, .250" dia., full flow filter adaptor to crankcase	X.87	K. 9008/Z	4	TTT
WASHER, spring, .250" dia., filter mounting top	X.87	K. 9008/Z		NNN
WASHER, spring, .312" dia., filter to mounting plate	X.87	K. 9009/Z	2	J
WASHER, spring, .312" dia., downtake exhaust pipe stay bolt	X.87	K. 9009/Z	1	HH
WASHER, spring, .312" dia., dynamo belt swivel arm bolt	X.87	K. 9009/Z	1	
WASHER, spring, .312" dia., dynamo mounting bracket	X.87	K. 9009/Z	4	WW/TT
WASHER, spring, .312" dia., engine mounting stud front face	X.87	K. 9009/Z	3	
WASHER, spring, .312" dia., lower crankcase retaining screws	X.87	K. 9009/Z	20	
WASHER, spring, .312" dia., oil filter stud	X.87	K. 9009/Z	4	OOO
WASHER, spring, .312" dia., oil filter stud	X.87	K. 9009/Z	2	NNN
WASHER, spring, .312" dia., coolant pump to adaptor stud	X.87	K. 9009/Z	4	
WASHER, spring, .312" dia., coolant pump to adaptor stud	X.87	K. 9009/Z	5	
WASHER, spring, .312" dia., wheelcase fitting bolts	X.87	K. 9009/Z	3	MM/NN
WASHER, spring, .437" dia., clutch casing retaining screw	X.87	K. 9011/Z	2	
WASHER, thrust, centre main bearing, lower half	67	RE. 4025	2	
WASHER, thrust, centre main bearing, upper half	68	RE. 4024	2	
WASHER, union body, adaptor casing to filter	X.83	KB. 1081	1	FP
WASHER, union body, adaptor casing to filter	X.83	KB. 1079	1	SSS
WASHER, union, adaptor casing	X.83	KB. 1186	2	J

GROUP E3, CRANKSHAFT.

Comprising:

CAP, oil retaining, crankpin	1	EB.3198	12	F
CAP, oil retaining, crankpin		RE.14143	12	G
CAP, oil retaining, journal (when rubber bung is fitted in No.7 journal)		EB.3197	11	F
CAP, oil retaining, journal (when cap is fitted in No.7 journal)		EB.3197	13	F
CAP, oil retaining, journal		RE.14142	13	G
CAP, oil, front journal		E. 76662	1	K
COLLAR, front journal		EW.2004	1	K
CRANKSHAFT, standard assembly, consisting of:	3	RE.9005A	1	H
Crankshaft		RE.9005	1	
Dowel, balance weight		E.56890	6	
Nut, full, .375" dia., balance weight	X.21	K.4010/Z	12	
Stud, .375" dia., balance weight		EW.1465	12	
Washer, lock, .375" dia., balance weight		EB.1031	12	
Weight, balance		RE.4056	6	
CRANKSHAFT, standard assembly, as above except:		RE.11561A	1	J
Crankshaft, standard		RE.11561	1	
DISC, expanding, No.7 journal (used when caps are not fitted in No.7 journal)		EB.4411	1	
KEY, Woodruff, .1265" x .625"	X.18	KC. 508	3	A
KEY, Woodruff, .126" x .625"	X.18	KC. 507	3	A
KEY, Woodruff, .1255" x .625"	X.18	KC. 506	3	A
KEY, Woodruff, .125" x .625"	X.18	KC. 505	3	A
NUT, castellated, 2 BA, crankpin stud	X.20	K. 4206/Z	6	
NUT, castellated, .250" dia., journal stud when rubber plug is fitted in No.7 journal	X.20	KB.3581/Z	6	
NUT, castellated, .250" dia., journal stud when cap is fitted in No.7 journal	X.20	KB.3581/Z	7	
PIN, split, .062" dia., crankpin stud	X.31	K. 4602/Z	6	
PIN, split, .062" dia., journal stud, when rubber plug is fitted in No.7 journal	X.31	K. 4602/Z	6	
PIN, split, .062" dia., journal stud, when oil cap is fitted in No.7 journal	X.31	K. 4602/Z	7	
PLUG, crankshaft, No. 7 journal (used when cap is not fitted)		RE. 7578	1	
STUD, 2 BA, crankpin, oil cap assembly (with nut K.4307/Z)		RE.9443	6	H
STUD, 2 BA, crankpin, oil cap assembly (with nut K.4307/Z)		RE.9443	4	J
SUTD, 2 BA, crankpin oil assembly (with nut K.4307/Z)		RE.11629	2	J
STUD, .250" dia., journal oil caps, assembly Nos.2,3,5 & 6 (with nuts K.4310/Z)	5	RE.9442	4	
STUD, .250" dia., journal oil cap, assembly No.4 only (with nuts K.4310/Z)	6	RE.9444	1	
STUD, long, front journal		RE. 133	1	K

GROUP E3 (Continued Overleaf)

GROUP E3. CRANKSHAFT. (Continued)

STUD, long, front journal bore, assembly, consisting of:-	7	RE.15104	1	L
Cap		RE.14654	1	
Collar		RE. 3953	1	
Stud		RE. 3951	1	
STUD, .250" dia., journal oil cap rear (with nut K.4310/Z) when oil cap is fitted on No.7 journal	8	RE. 9441	1	
WASHER, aluminium, 2 BA, crankpin stud		RE. 6976	17	
WASHER, aluminium, .250" dia., journal studs	X.83	KB. 1076	13	

GROUP E4. CYLINDER HEAD.

Comprising:

ADAPTOR, oil filler cap	1	RE.11318	1	J
BOLT, breather housing	2	RE. 5465	1	M
BUSH, centre, to suit .312" dia., studs	3	RE. 3402	1	LLL
BUSH, centre to suit, .375" dia., studs		RE. 7571	1	MMM/J
BUSH, rubber, rocker cover stud	4	EB. 3998	1	
CAP, oil filler, assembly	5	RE.13817	1	H
CAP, oil filler, assembly (English) with: Stud	6	RE.15934	1	J
		RE.10854	1	
CAP, oil filler assembly, (French) as above except plate		RE.16819	1	J
CATCH, oil filler	7	E.89147	1	J
COVER, rocker, when crankcase breather is fitted	8	RE. 3762	1	H
COVER, rocker, when breather is fitted to rocker cover		RE. 5768	1	H
COVER, rocker		RE.10479	1	J
COVER, rocker, for use with O.B. air cleaner		RE. 6196	1	H
COVER, rocker, for use with O.B. air cleaner		RE.14706	1	J
HEAD, cylinder, assembly, consisting of:	9	RE. 3680	1	LLL
Adaptor sparking plug (standard)		RE. 3682	6	A
Adaptor, sparking plug (.009" o/s on external thread)		RE. 4818	6	A
Adaptor, sparking plug (.010" o/s on external thread)		RE. 4819	6	A
Adaptor, sparking plug (.062" o/s on external thread)		RE.13502	6	A
Cover end rear		EB. 4002	1	
Guide, inlet, valve (standard)		RE. 361	1	
Guide, inlet, valve (.002 o/s)		RE.14507	1	
Joint, end cover		RE. 3422	1	
Plug, core hole		RE. 9018	10	*
Plug, core hole		RE. 9018	8	+
Plug, core hole		RE. 9015	2	+

GROUP E4. (Continued Overleaf)

GROUP E.4 CYLINDER HEAD. (Continued)

HEAD, cylinder, assembly, consisting of: (Continued)

Plug, oil drilling	X.27	KB.1054/Z	1	
Ring, locking, sparking plug adaptor, standard size		RE.3681	6	
Ring, locking, sparking plug adaptor, .005" o/s thread		RE.4816	As requd.	
Ring, locking, sparking plug adaptor, .010" o/s thread		RE.4817	As requd.	
Ring, locking, sparking plug adaptor, .062" o/s thread		RE.13501	As requd.	
Screw, countersunk, 2 BA, rear end cover	X.50	K.2813/Z	10	
Seat, valve inlet standard size		EB.4001	6	
Seat, valve inlet (.002" o/s)		RE.14503	6	
Seat, valve inlet (.005" o/s)		RE.14504	6	
Seat, inlet valve (.010" o/s)		RE.14505	6	
Seat, inlet valve (.050" o/s)		RE.14506	6	
Stud, 2 BA, ignition wire conduit retaining	X.62	KB.299/Z	4	
Stud, .250" dia., hot spot facing	X.68	KB.352/Z	2	
Stud, .250" dia., inlet flange (L.C)	X.68	KB.357/Z	8	
Stud, .250" dia., inlet flange (R.C)	X.68	KB.354/Z	8	
Stud, .312" dia., rocker cover retaining		EB.4006	3	
Stud, .312" dia., rocker pedestal retaining		EB.3997	5	
Stud, .312" dia., thermostat, long	X.73	KB.410	2	
Stud, .312" dia., thermostat, short	X.73	KB.404	2	
Washer, aluminium, oil drilling plug	X.83	KB.1077	1	
HEAD, cylinder as above except:		RE.7753	1	MMM
Adaptor, heater, feed tap (when outlet is from No.2 plug)		RE.8952	1	
Plug, core hole, .875" dia.,		RE.9018	10	*
Plug, core hole, .875" dia.		RE.9018	8	+
Plug, core hole, .875" dia.		RE.9015	2	+
Plug, core hole, .875" dia.		RE.9018	7	⊙
Plug, core hole No.5 cylinder		RE.10422	1	⊙
HEAD, cylinder as above except:		RE.10429	1	J
Adaptor, heater feed tap		RE.9888	1	
Plug, core, hole No.5 cylinder		RE.13406	1	
Stud, adaptor oil filler to rocker cover	X.68	KB.352/Z	2	
INSERT, breather (when breather is fitted to rocker cover)		RE.5464	1	
JOINT, water outlet connection	10	EB.4004	1	
JOINT, hot spot to cylinder	11	EB.3581	1	
JOINT, inlet manifold to cylinder	12	EB.4003	4	
JOINT, rocker cover to cylinder	13	RE.10477	1	
NUT, adaptor, oil filler cap to rocker cover	X.24	K.4310/Z	2	J
NUT, castellated oil filler cap	14	RE.10853	1	J
NUT, cap, rocker cover retaining	14A	RE.9032	3	
NUT, full, .250" dia., hot spot connection	X.21	K.4008/Z	2	
NUT, full, .250" dia., air intake, silencer (L.C)	X.21	K.4008/Z	2	

GROUP E4 (Continued Overleaf)

GROUP E4. CYLINDER HEAD. (Continued)

NUT, full, .250" dia., air intake, silencer (R.C)	X.21	K. 4008/Z	4	Q
NUT, full, .250" dia., inlet manifold	X.21	K. 4008/Z	8	
NUT, half, 2 BA, ignition conduit retaining	X.24	K. 4307/Z	4	
NUT, half, 2 BA, No.5 core plug	X.24	K. 4307/Z	1	⊕
NUT, half, .250" dia., air intake anchor bracket (R.C)	X.24	K. 4310/Z	2	R
NUT, half, .250" dia., air intake anchor bracket (R.C)	X.24	K. 4310/Z	4	S
NUT, half, .250" dia., air intake anchor bracket (R.C)	X.21	K. 4008/Z	4	J
NUT, half, .250" dia., heater pipe clip and shield or oil bath support where fitted.	X.24	K. 4310/Z	2	+ ⊕
NUT, half, .312" dia., rocker pedestal stud	X.24	K. 4313/Z	5	
NUT, half, .312" dia., thermostat	X.24	K. 4313/Z	4	
PIECE, distance, oil bath (where fitted)		RE.7069	2	
PIN, hinge, oil filler	15	E.88941	2	J
PIN, split, oil filler caps stud	X.31	K. 4648/Z	1	J
PIPE, breather assembly	16	RE.5778	1	M
PLATE, pressure, oil filler cap	17	RE.88931	1	J
PLATE, rocker cover, rubber bush	18	EB.3999	3	
PLUG, .250" dia., rocker cover (R.C)	X.27	KB.1052/Z	2	
SPRING, pressure, oil filler cap	19	FB.2484	1	J
STUD, .250" dia., Nos. 4 & 6 core plug	X.66	KB. 750/Z	2	+ ⊕
STUD, .250" dia., Nos. 4 & 6 core plug	X.68	KB. 399/Z	2	⊕
STUD, .250" dia., air silencer brackets (R.C)	X.65	KB.3825/Z	4	Q
STUD, .250" dia., air silencer brackets (R.C)	X.68	KB. 351/Z	2	R
STUD, .250" dia., air silencer brackets (R.C)	X.68	KB. 351/Z	4	S
STUD, .250" dia., air silencer brackets (L.C)	X.68	KB. 351/Z	2	
STUD, .250" dia., rocker cover	X.68	KB. 399/Z	2	J
STUD, 2 BA, No.5 core plug		RE.10440	1	⊕
SPRING, catch, filler cap	20	E.89148	1	J
TAP, heater	21	RE.5150	1	
WASHER, bevelled air silencer bracket (L.C)		RE.6920	2	
WASHER, joint, oil filler adaptor to rocker cover	22	RE.11319	1	J
WASHER, locking adaptor to rocker cover	X.89	KB.7106	2	J
WASHER, oil filler cap with eyelet and washer	23	RE.9457	1	J
WASHER, oil filler cap	24	EB.5064	1	H
WASHER, oil filler cap stud	X.85	K. 4401/Z	1	J
WASHER, plain heater tap	25	RE.4787	1	
WASHER, plain, .250" dia., rocker cover	X.83	KB.1076/W	2	
WASHER, plain, 2 BA, ignition conduit stud	X.85	K. 4404/Z	4	
WASHER, plain, 2 BA, No.5 core plugs	X.85	K. 4404/Z	1	⊕
WASHER, plain, .250" dia., Nos. 4 & 6 core plugs	X.85	K. 4407/Z	2	⊕
WASHER, plain, .250" dia., Nos. 4 & 6 core plugs		KB.3905/Z	2	⊕
WASHER, plain, .312" dia., rocker pedestal stud	26	E.50051	5	
WASHER, spigot oil filler		RE.3805	2	J
WASHER, spring, 2 BA, ignition conduit	X.87	K. 9006/Z	4	
WASHER, spring, 2 BA, No.5 core plug	X.87	K. 9006/Z	1	⊕
WASHER, spring, .250" dia., Nos.4 & 6 core Plug	X.87	K. 9008/Z	2	+ ⊕

GROUP E4. (Continued Overleaf)

GROUP E 4. CYLINDER HEAD. (Continued)

WASHER, spring, .250" dia., air intake silencer (R.C)	X.87	K. 9008/Z	4	Q
WASHER, spring, .250" dia., air intake silencer (R.C)	X.87	K. 9008/Z	2	
WASHER, spring, .250" dia., air intake silencer (R.C)	X.87	K. 9008/Z	4	SJ
WASHER, spring, .250" dia., air intake silencer (L.C)	X.87	K. 9008/Z	2	
WASHER, spring, .250" dia., rocker cover (R.C)	X.87	K. 9009/Z	2	
WASHER, spring, .250" dia., hot spot connection	X.87	K. 9008/Z	2	
WASHER, spring, .250" dia., inlet manifold	X.87	K. 9008/Z	8	
WASHER, spring, .312" dia., thermostat	X.87	K. 9009/Z	4	

- NOTES:
- * When heater pipe is taken from No.5 core hole.
 - + When heater pipe is taken from No.5 core hole and oil bath air cleaner is fitted.
 - ⊕ When heater pipe is taken from No.2 core hole with or without an oil bath air cleaner.
 - ⊗ When heater pipe is taken from No.2 core hole without oil bath air cleaner.
 - ⊙ When heater pipe is taken from No.2 core hole with oil bath air cleaner.

GROUP E5. FLYWHEEL.

Comprising:

BEARING, ball first motion shaft	1	RE.12055	1	
BOLT, .312" dia., clutch cover to friction plate	X.5	KB. 2811/Z	6	
BOLT, .312" dia., friction plate and flywheel flexible disc	X.11	K. 312/Z	3	
BOLT, .375" dia., flexible disc and housing to crankshaft	2	GB. 4427	12	
DISC, flexible driving, 10" clutch	3	GB. 5013	1	P
DISC, flexible driving, 11"		GB. 5292	1	T
FLYWHEEL, 10" clutch type, (R.C)	4	RG. 3096	1	P
FLYWHEEL, 11" clutch type, (R.C)		RE.10694	1	T
FLYWHEEL, 10" clutch type, (L.C)		RG. 5543	1	P
FLYWHEEL, 11" clutch type, (L.C)		RE. 9984	1	T
HOUSING, ball bearing	5	GB. 4420	1	
NUT, full, .312" dia., clutch cover to friction plate (6) friction plate and flywheel to flexible disc.	X.21	K. 4009/Z	9	
NUT, full, .375" dia., flexible disc and housing to crankshaft	X.21	K. 4010/Z	12	
PLATE, clutch friction 10"	6	RG. 3021	1	P
PLATE, clutch friction 11" (Borglite)		RE.10695	1	U
PLATE, clutch friction 11"		GB. 5291	1	V
WASHER, Grover, .312" dia., clutch cover to friction plate	X.81	K. 4509/Z	6	

GROUP E6. OIL PUMP AND RELIEF VALVE.

Comprising:

CAP, valve assembly with:	1	RE. 5974	1	W
Cap		E. 87826	1	
Pin guide		RE. 5701	1	
Spring		EB. 5029	1	
CAP, valve, H.P. assembly with:		RE. 11036	1	X
Cap.		RE. 11037	1	
Pin guide		RE. 11044	1	
Spring		EB. 5029	1	
CAP, valve L.P. with:	2	RE. 5975	1	W
Cap		E. 87829	1	
Pin, guide		RE. 5702	1	
Spring		EW. 1542	1	
CAP, valve L.P. with:		RE. 11038	1	X
Cap		RE. 11039	1	
Pin, guide		RE. 11045	1	
Spring		EW. 1542	1	
CASING, relief valve, assembly, consisting of:	3	EB. 3890	1	W
Casing		EB. 3890	1	
Plug, core hole		E. 84973	2	
Seating, L.P. valve		E. 87055	1	
Seating, H.P. valve		E. 87056	1	
CASING, relief valve, assembly, consisting of:		RE. 11059	1	XH
Casing		RE. 11033	1	
Plug, core hole		E. 84973	2	
Seating, L.P. valve		RE. 11035	1	
Seating, H.P. valve		RE. 11034	1	
CASING, relief valve, assembly, as above except: for casing and plug E.84973 (3) off		RE. 14647	1	J
CASING, oil pump, assembly, consisting of:	4	RE. 9863	1	
Bush, shaft lower		EB. 3905	1	
Bush, shaft upper		EB. 3904	1	
Casing		RE. 3927	1	
Cover		EB. 3896	1	
Pin, taper, .156" x 1.000" long	X.33	K. 4710	1	
Spindle, driven gear		EB. 3906	1	
Stud, 2 BA, union lock plate	X.63	KB. 250/Z	1	
Stud, .250" dia., cover retaining	X.68	KB. 352/Z	6	
CONNECTION, banjo, relief valve	5	E. 85380	1	

GROUP E6. (Continued Overleaf)

GROUP E6. OIL PUMP AND RELIEF VALVE. (Continued)

FLOAT, suction pipe assembly	6	RE. 4028	1	
GEAR, driven, pump chamber, assembly, with bush E.86835 1 off	7	EB. 9760	1	
GEAR, driving, pump chamber	8	EB. 3898	1	
JOINT, valve cap H.P. .812" dia.	X.83	KB. 1089	1	
JOINT, valve, cap L.P. .875" dia.	X.83	KB. 1083	1	
KEY, Woodruff, gear chamber	X.18	KC. 501	1	
LOCK, plate, delivery plate union nut	9	EB. 3903	1	
NUT, full, 2 BA, union lock plate	X.21	K. 4006/Z	1	
NUT, full, .250" dia., cover	X.21	K. 4008/Z	6	
NUT, half, .312" dia., chamber gear to drive shaft	X.24	K. 4313/Z	1	
PIN, taper, .125" dia., x 1.000" long, suction pipe	X.32	K. 4802	1	
PIPE, delivery, assembly, consisting of:	10	RE. 9853	1	
Flange		EB. 3902		
Nipple		E. 86663	1	
Nut		E. 86653	1	
Pipe		EB. 3901	1	
PUMP, oil assembly, complete		RE. 9862	1	
SHAFT, driving oil pump	11	RE. 13399	1	*
UNION, delivery pipe, pump casing	12	E. 86643	1	
UNION, .312" dia., pipe relief valve	13	EB. 4174	1	H
VALVE, H.P. & L.P.	14	E. 87823	2	
WASHER, aluminium, banjo connection	15	RE. 3523	2	
WASHER, aluminium, .625" dia., union	X.83	KB. 1081	1	H
WASHER, aluminium, .875" dia., delivery pipe union	X.83	KB. 1083	1	
WASHER, lock, 2 B.A, union lock plate stud	X.89	KB. 7104	1	
WASHER, lock, .250" dia., cover stud	X.89	KB. 7106	6	
WASHER, plain, 2 BA, union lock plate stud	X.85	KB. 4404/Z	1	
WASHER, plain, .312" dia., drive shaft	X.85	K. 4410/Z	1	

NOTE: * The new type drive shaft is integral with the gear.
Key and taper pin no longer used.

GROUP E7. SPRING DRIVE.

Comprising:

BOLT, damper wheel	1	RE. 3946	6	L
CAP, thrust, spring retaining		EW. 1987	8	K
DOG, driven assembly, with bush EW.938 1 off		RE. 145	1	K
DOG, starting		EW. 1056	1	K
DOG, starting	2	RE. 4033	1	L
DRUM, friction	3	RE. 6714	1	
FLYWHEEL, damper rear, assembly with 2 BA, stud KB.656 12 off		EW. 931A	1	K
FLYWHEEL, front assembly, with bush EB.3225 1 off		RE. 7147	1	K

GROUP E7. (Continued Overleaf)

GROUP E7. SPRING DRIVE. (Continued)

HUB, wheel assembly with bearing RE.3937 1 off	4	RE.4032A	1	L
KEY, Woodruff, front flywheel to pulley	X.18	KC. 503	1	K
KEY, Woodruff, pulley, .125" thick	X.18	KC. 505	1	AL
KEY, Woodruff, pulley, .1255" thick		KC. 506	1	AL
KEY, Woodruff, pulley, .1260" thick		KC. 507	1	AL
KEY, Woodruff, pulley, .1265" thick		KC. 508	1	AL
NUT, Cap fan pulley retaining		EW.1057	1	K
NUT, crankshaft, driving drum retaining	5	EB.3227	1	
NUT, half, 2 BA, front to rear flywheel stud	X.21	K. 4006	12	K
NUT, half, .250" dia., damper wheels and pinion	X.24	K. 4310/Z	10	L
NUT, half, .250" dia., front flywheel to driven dog retaining	X.24	K. 4310/Z	4	K
NUT, withdrawal, fan pulley		E.54555	1	K
PIECE, distance, pinion to driven dog assembly with stud, RE.214, 4 off		RE. 162A	1	K
PIN, dog driving		RE.163	2	K
PINION, crankshaft, 27 teeth		RE.146	1	K
PINION, assembly consisting of:	6	RE.3938	1	L
Bearing		RE.3936	1	
Pinion		RE.3938	1	
Stud, .250" dia.,		KB. 352/Z	4	
PLATE, dog locking		RE.4034	1	
PLATE, pressure assembly consisting of:		EW. 934A	1	K
Plate		EW. 934	1	
Rivet, .125" dia.,	X.40	KB.1854	24	
Spigot, springs		EW.1986	8	
Spring		EB.2644	1	
PLATE, spring assembly consisting of:	8	RE.3942A	1	L
Plate, pressure		RE.3941	1	
Plate, spring		RE.3942	1	
Rivet, .125" dia.,	X.40	KB.1854	12	
Rivet, .125" dia.	X.40	KB.1866	6	
Spigot, damper spring		RE.3944	6	
PLATE, star locking starting dog		EW.1097	1	K
PULLEY, fan		EB.5014	1	K
PULLEY, fan	9	RE.4031	1	L
SCREW, cheese head, .250" dia. lockplate	X.47	K.2010/Z	2	L
SCREW, 3 BA, star plate to pulley retaining	X.45	K.1801/A	5	K
SCREW, countersunk head, 2 BA, crankshaft pinion to driven dog, retaining	X.50	K.2819	2	K
SPRING, damper	10	RE.3943	6	L
SPRING, driving inner	11	E.57758	8	
SPRING, driving outer	12	E.58239	8	
SPRING, thrust front flywheel		EW.1347	8	K
WASHER, damper springs	X.86	K. 8808/Z	-	ZB
WASHER, friction cotton	13	EW.935	2	
WASHER, locking crankshaft nut	14	EB.3228	1	
WASHER, lock, damper wheel bolt	15	RE.3947	6	L
WASHER, lock 2 BA, front to rear flywheel stud		E.54566	12	K

GROUP E7. (Continued Overleaf)

GROUP E7. SPRING DRIVE. (Continued)

WASHER, lock, .250" dia., front flywheel to driven dog nut	X.89	KB. 2954	4	K
WASHER, lock, thrust spring cap	X.89	KB. 2961	8	K
WASHER, plain, crankshaft nut	16	EB. 3226	1	
WASHER, spring, 3 BA, star plate retaining screw	X.87	K. 9005	5	K
WASHER, thrust spring adjusting		EW. 1708	8	K
WASHER, spring, .250" dia., lockplate	X.87	K. 9008/Z	2	L
WASHER, tab, locking pinion studs	X.89	KB. 7106	4	L
WHEEL, damper front	17	RE. 4030	1	L
WHEEL, damper rear	18	RE. 3940	1	L

GROUP E8. VALVE MECHANISM.

Comprising:

ARM, rocker, inlet valve R.H. assembly with bush EB.4198	1	RE. 13974	3	
ARM, rocker, inlet valve L.H. assembly with bush EB.4198	2	RE. 13975	3	
CAMSHAFT, (High Lift) with studs KB.752/Z 4 off	3	RE. 5157	1	FF
CAMSHAFT, (Low Lift) with studs KB.752/Z 4 off		RE. 6885	1	GG
GEAR, camshaft, driving assembly with hub RE.6656, not supplied separately	4	RE. 6657	1	A
GEAR, camshaft, aluminium	5	RE. 9346	1	A
NUT, gear retaining (for use when stud is fitted to camshaft)	X.24	K. 4310/Z	4	
NUT, lock, exhaust tappet adjusting	6	G. 80757	6	
NUT, lock, inlet tappet adjusting	7	B. 11588	6	
PACKING, inlet valve stem	8	EB. 1886	6	
PEDESTAL, rocker shaft centre	9	EB. 3993	1	
PEDESTAL, rocker shaft front	10	EB. 3991	1	
PEDESTAL, rocker shaft, intermediate and rear	11	EB. 3992	1	
PLATE, locking, camshaft gear (for use with aluminium gear)	12	RE. 7172	1	
PLUG, .437" dia., rocker shaft ends	X.27	KB. 1058/Z	2	
PLUNGER thrust	13	EB. 4024	1	
RING, spring, inlet valve retaining	14	EB. 1747	6	
ROD, push, inlet valve operating	15	RE. 13538	6	
SCREW, countersunk head, 3 BA, front pedestal	X.49	K. 2701/Z	1	
SCREW, exhaust tappet adjusting	16	RE. 7648	6	
SCREW, hexagon head, .250" dia., gear to camshaft (not required when stud is fitted to camshaft)	X.55	KC. 904/Z	4	
SCREW, inlet tappet adjusting	17	RE. 13539	6	
SHAFT, rocker	18	RE. 13537	1	
SPRING, rocker	19	RE. 13536	4	*
SPRING, thrust	20	EB. 4023	1	
SPRING, valve exhaust	21	RE. 3955	6	HH

GROUP E8. (Continued Overleaf)

GROUP E8. VALVE MECHANISM. (Continued)

SPRING, valve exhaust		RE. 3954	6	J
SPRING, valve inner, inlet	22	E. 86364	6	FF
SPRING, valve outer, inlet	23	E. 88325	6	FF
SPRING, valve inner, inlet		RE. 6793	6	GG
SPRING, valve outer, inlet		RE. 6794	6	GG
TAPPET, exhaust valve			6	
1.18675 to 1.1870		<u>BLUE</u>	24	RE.11782
1.1870 to 1.18725		<u>GREEN</u>		RE.11783
1.18725 to 1.1875		<u>YELLOW</u>		RE.12971
1.1875 to 1.18775		<u>BLACK</u>		RE.12972
1.18775 to 1.1880		<u>BLACK+YELLOW</u>		RE.15178
1.1880 to 1.18825		<u>GREEN+YELLOW</u>		RE.15179
TAPPET inlet valve			6	
1.18675 to 1.1870	25	RE.15164		
1.1870 to 1.18725		RE.15165		
1.18725 to 1.1875		RE.15166		
1.1875 to 1.18775		RE.15167		
1.18775 to 1.1880		RE.15168		
1.1880 to 1.18825		RE.15169		
VALVE, exhaust	26	RE.3043	6	
VALVE, inlet	27	EB.3853	6	
WASHER, aluminium, .437" dia. rocker shaft plug	X.83	KB.1079	2	
WASHER, lock, .250" dia., gear to camshaft screw	X.89	KB.7106	4	
WASHER, valve, spring exhaust bottom (to suit flanged valve guides)	28	RE.5892	6	KK
WASHER, valve spring exhaust, bottom (to suit non-flanged valve guides)		RE.3073	6	JJ
WASHER, valve spring exhaust bottom		RE.976	6	J
WASHER, valve spring, exhaust top	29	RE.5891	6	KK
WASHER, valve spring, exhaust bottom		RE.975	6	J
WASHER, valve spring, inlet bottom inner	30	RE.3679	6	
WASHER, valve spring, inlet bottom outer	31	RE.3900	6	
WASHER, valve spring, inlet top	32	B.86941	6	
WEDGE, inlet and exhaust valve retaining	33	EB.1748	12	

NOTE: * Four springs have replaced two pairs of distance pieces. One spring can be used to replace any one distance piece.

GROUP E9. WHEELCASE.

Comprising:

BUTTON, camshaft thrust	1	RE.3493	1	
CASING, assembly, dowel type, with .312" dia. stud KB.402/Z 1 off	2	RE.3473A	1	LL
CASING, assembly to suit fitting bolt with stud KB.402/Z 1 off		RE.6230	1	MM
CASING, assembly to suit bench type spring drive with stud KB.402/Z 1 off		RE.4029	1	NN

GROUP E9. (Continued Overleaf)

GROUP E9. WHEELCASE. (Continued)

CONNECTION, timing gear oil supply	3	EB.5017	1
NUT, full, .312" dia., engine mounting retaining	X.21	K. 4009/Z	1
NUT, half, .312" dia., camshaft thrust button retaining	X.24	K. 4313/Z	1
WASHER, aluminium, .312" dia., camshaft thrust button	X.83	KB.1077	1
WASHER, aluminium, .437" dia., timing gear oil supply connection	X.83	KB.1079	1
WASHER, spring, .312" dia., engine mounting stud	X.87	K. 9009/Z	1

NOTE:

Only one of the engine mounting studs is screwed into the wheelcase. The remaining three pass through the wheelcase and screw into the crankcase. They will be found in Section E2.

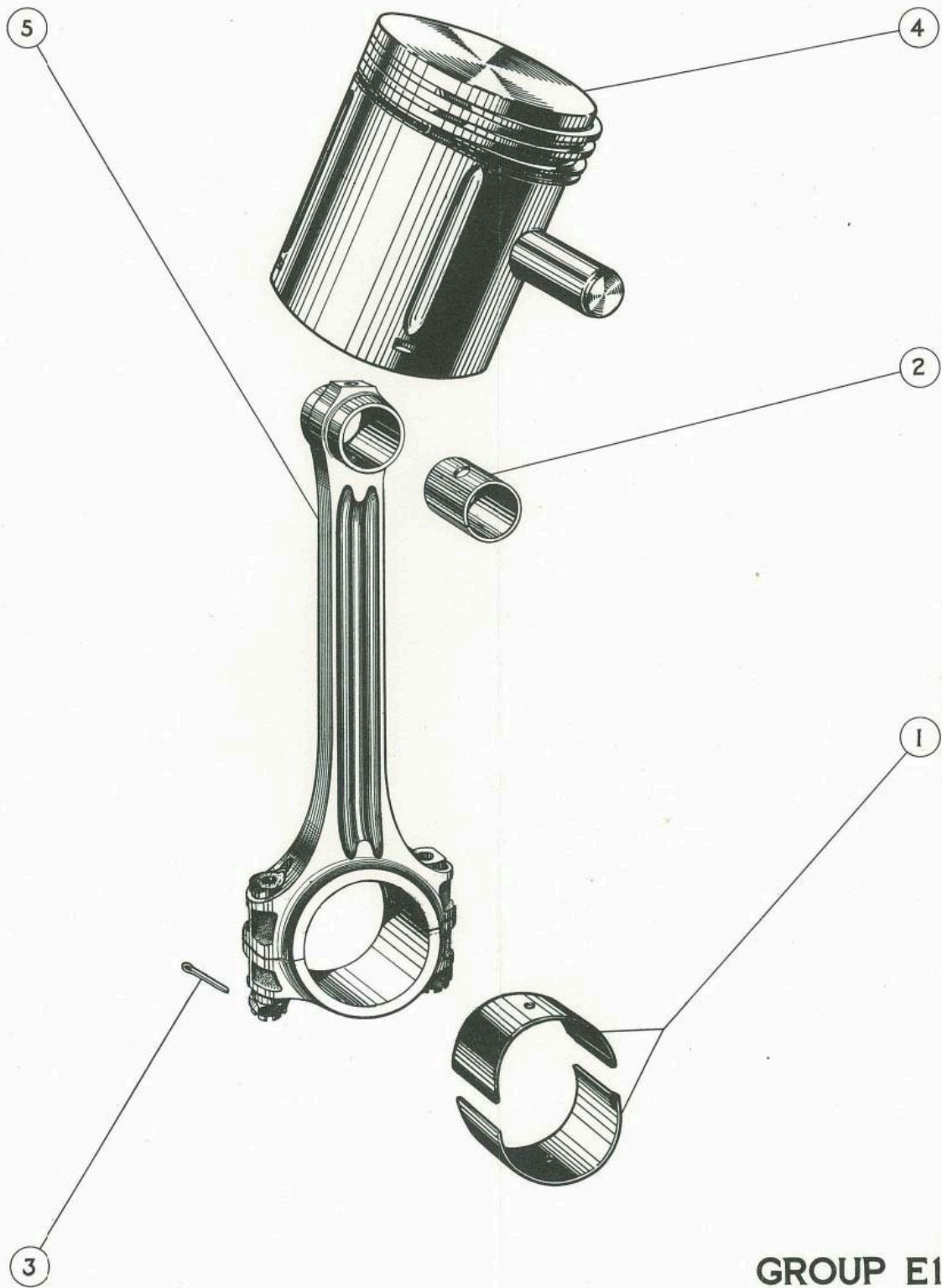

GROUP E1



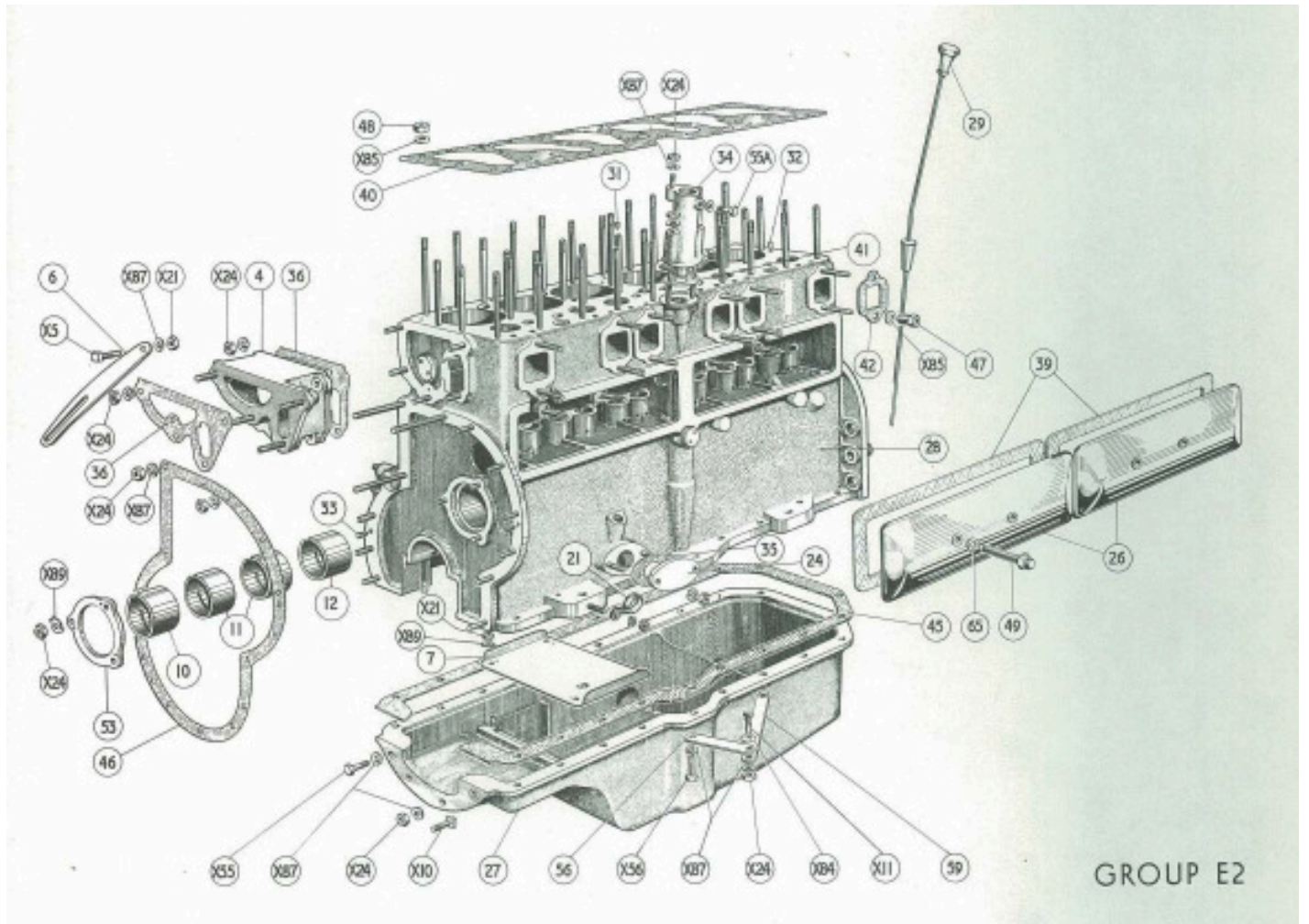

GROUP E2

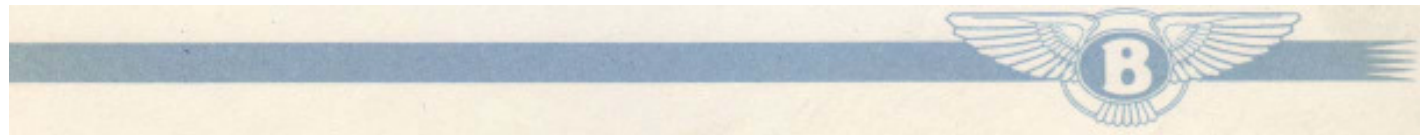

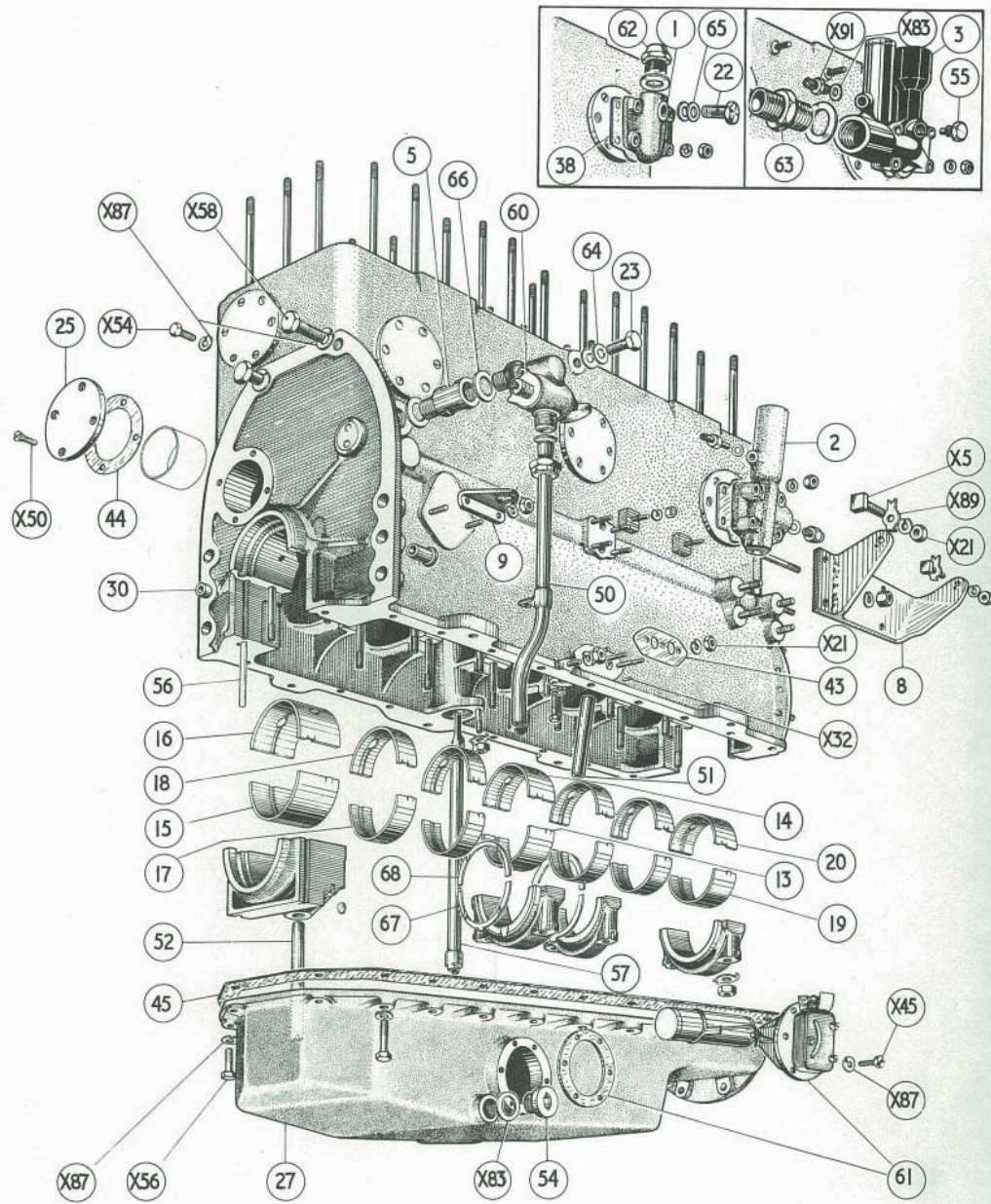

GROUP E2



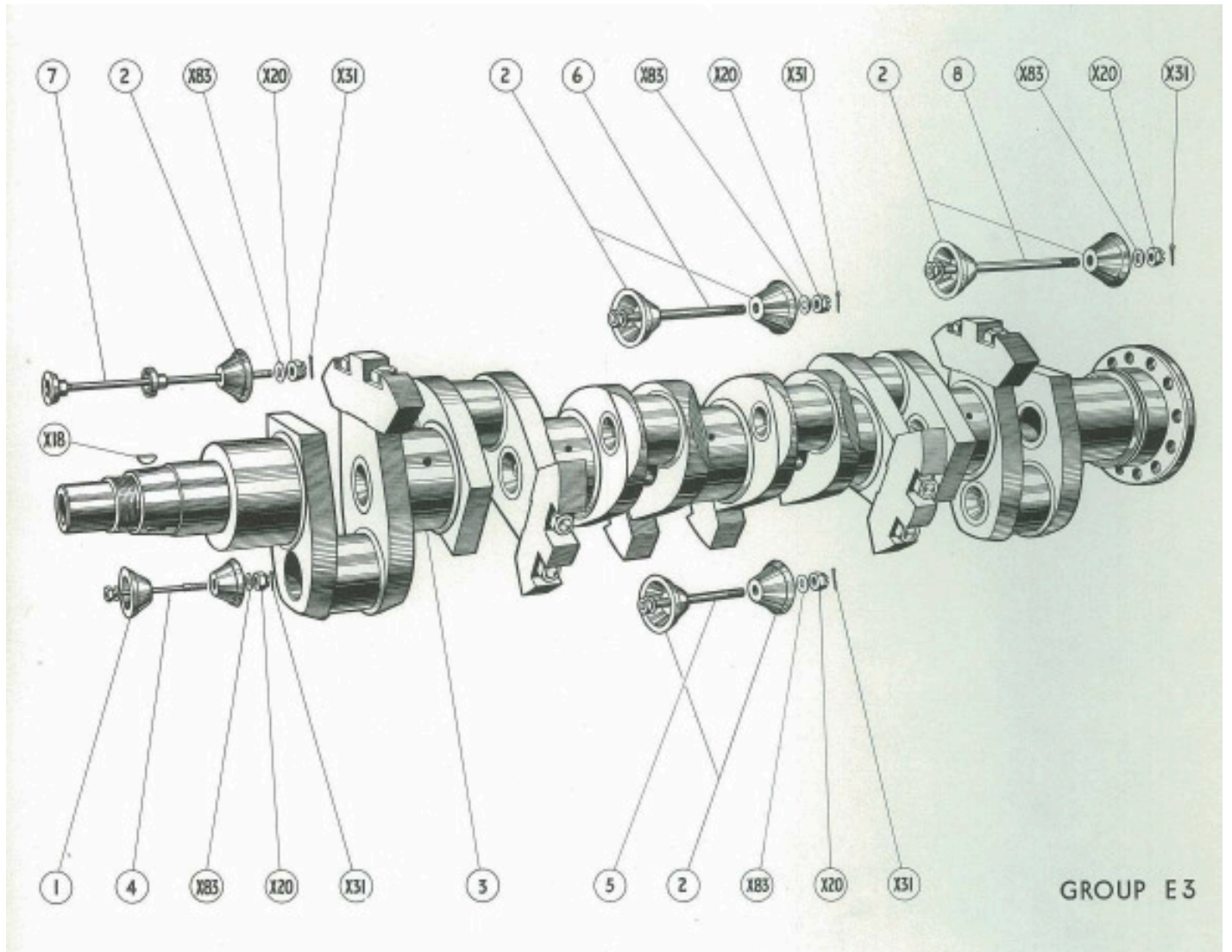

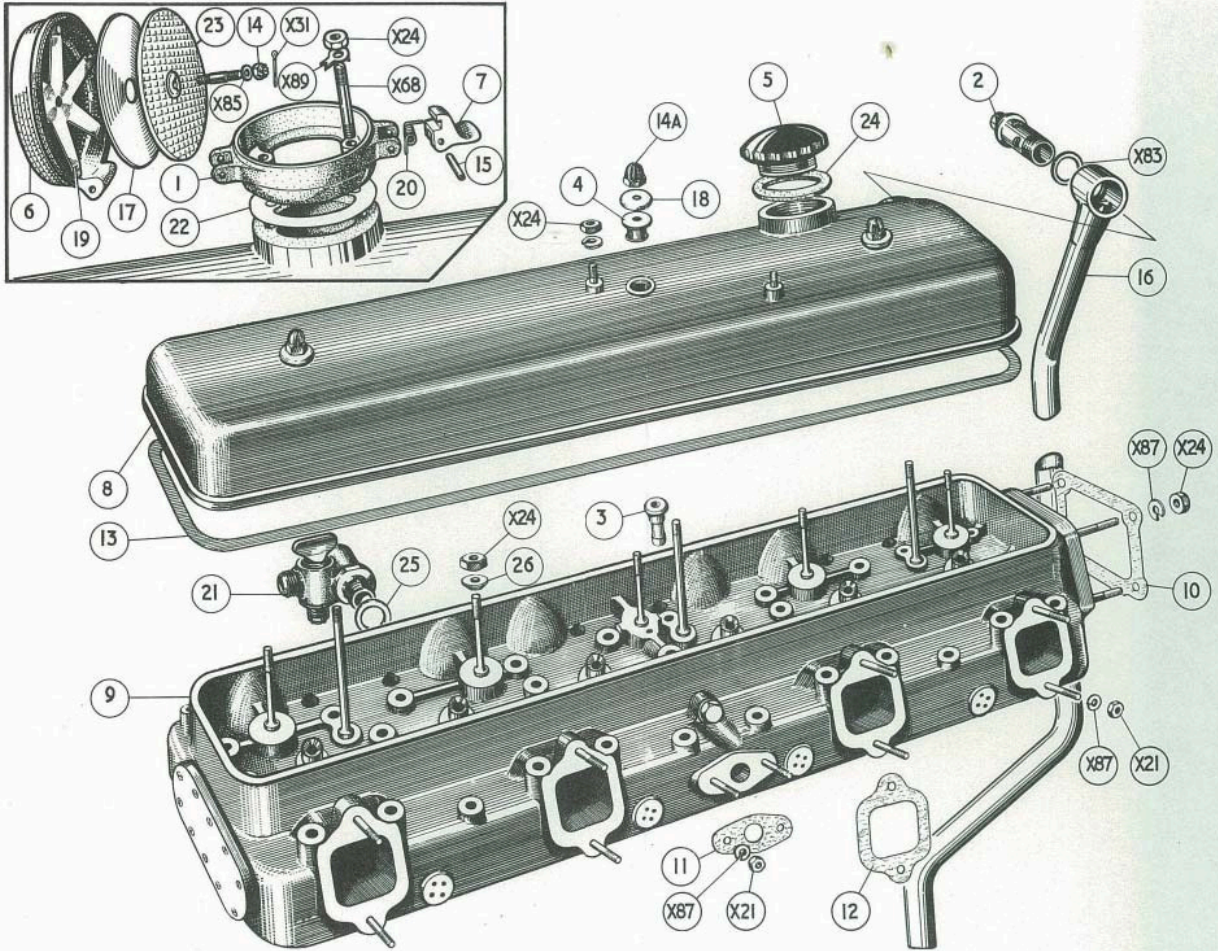

GROUP E4



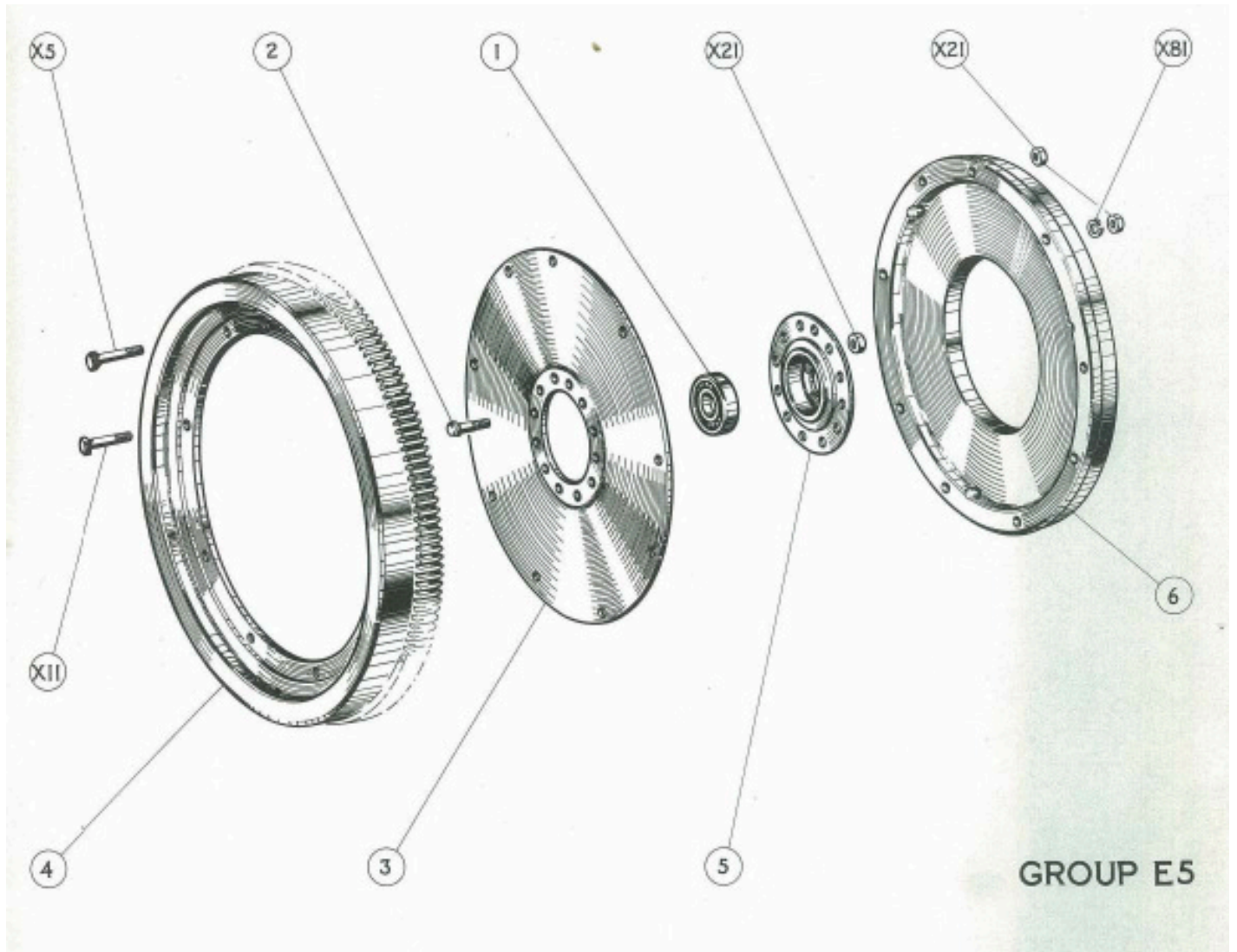

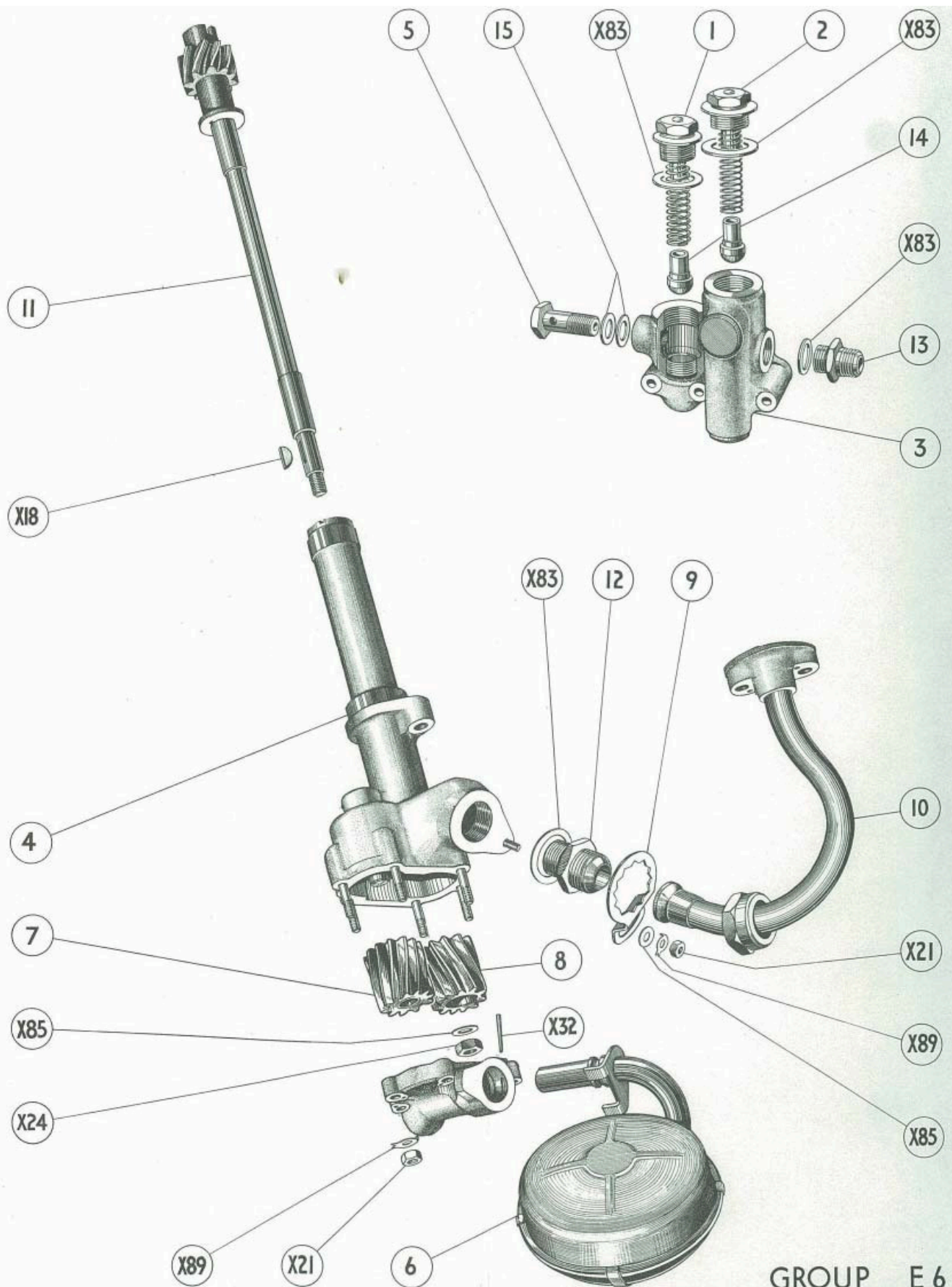

GROUP E 6



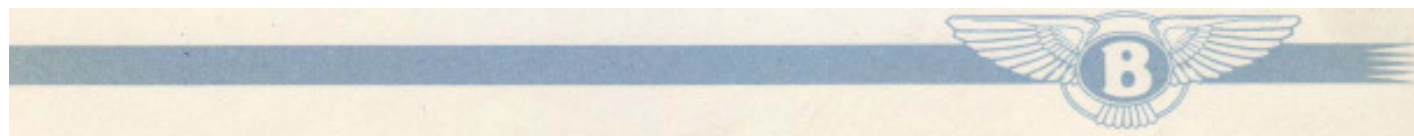
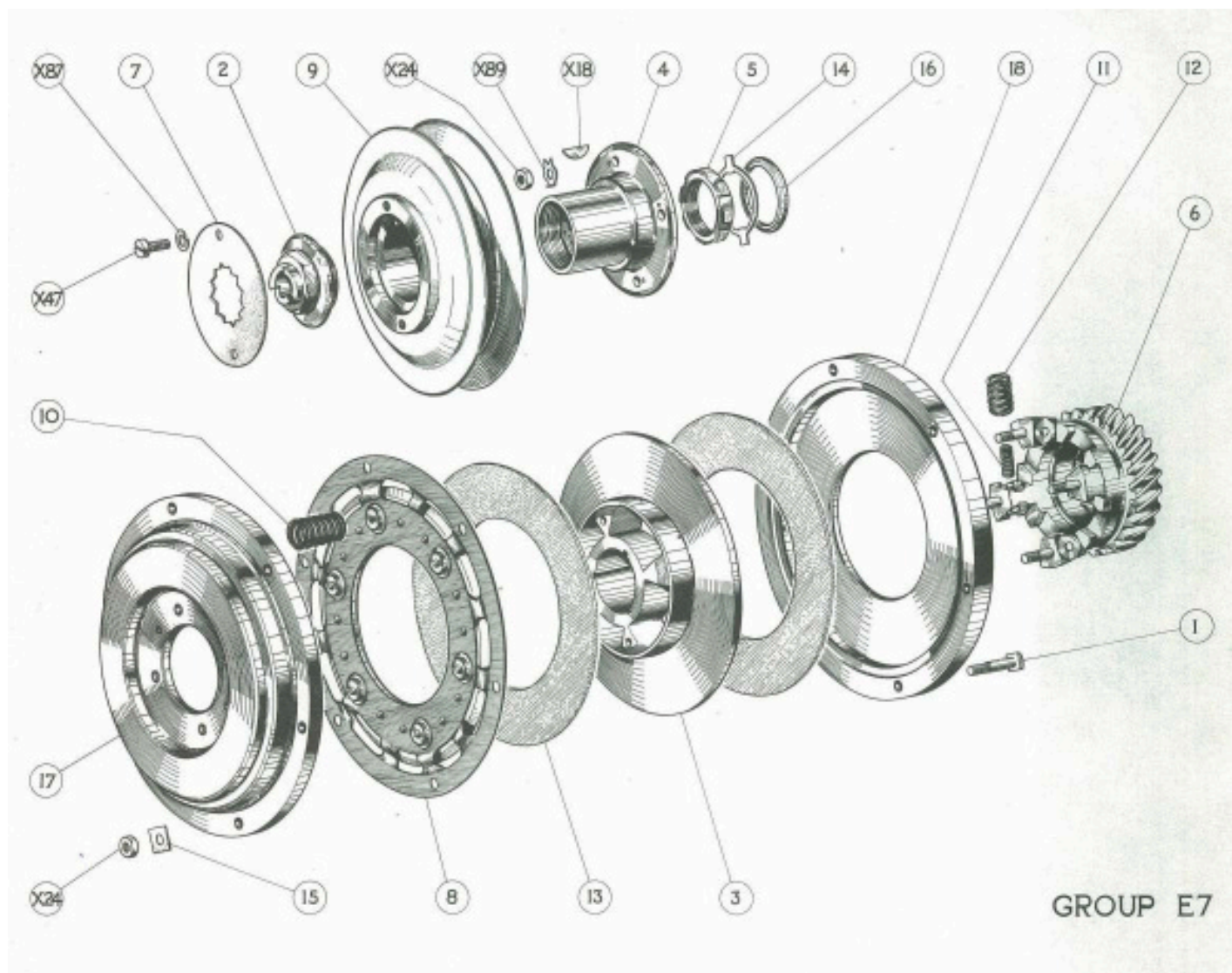

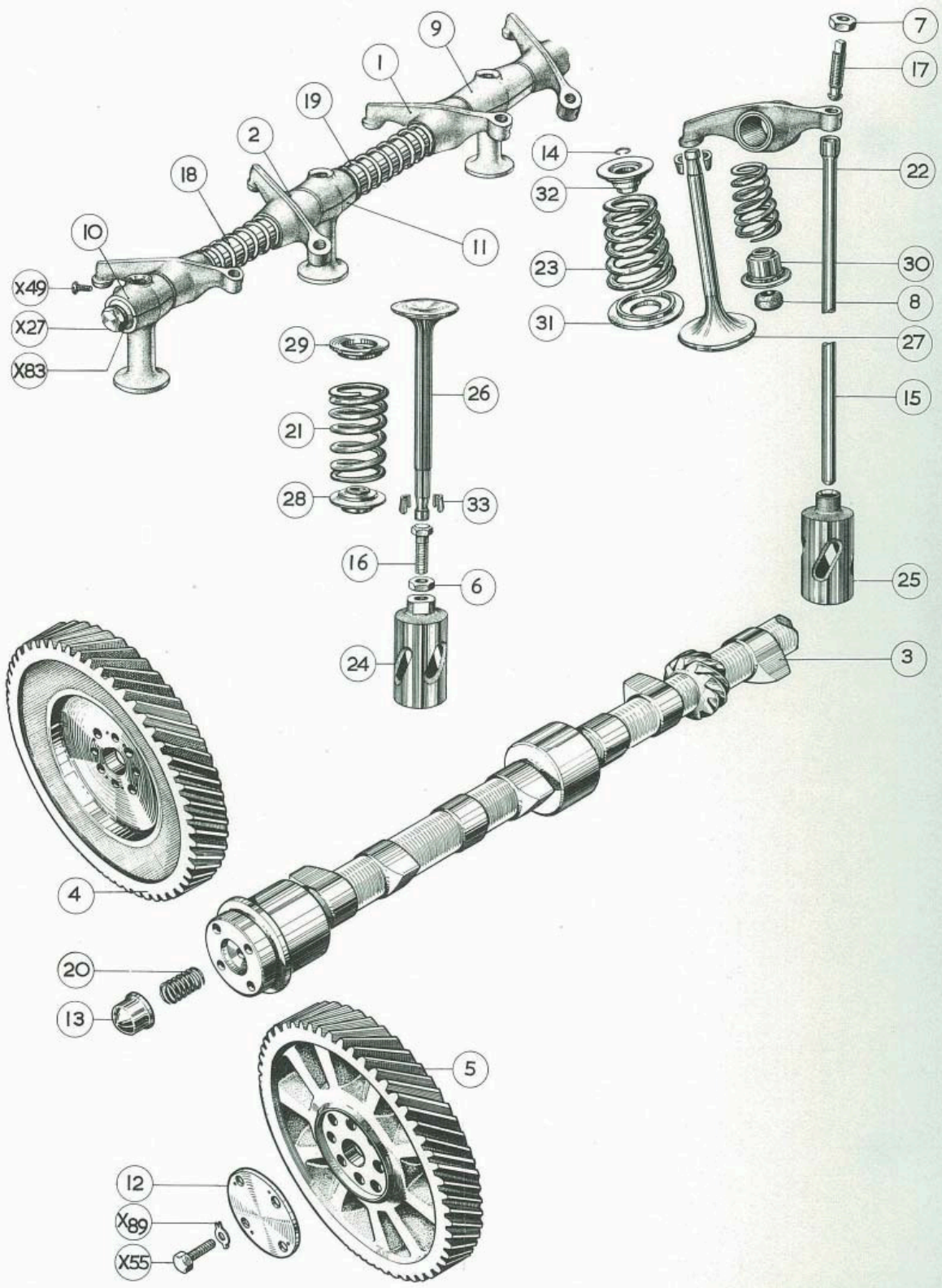

GROUP E8



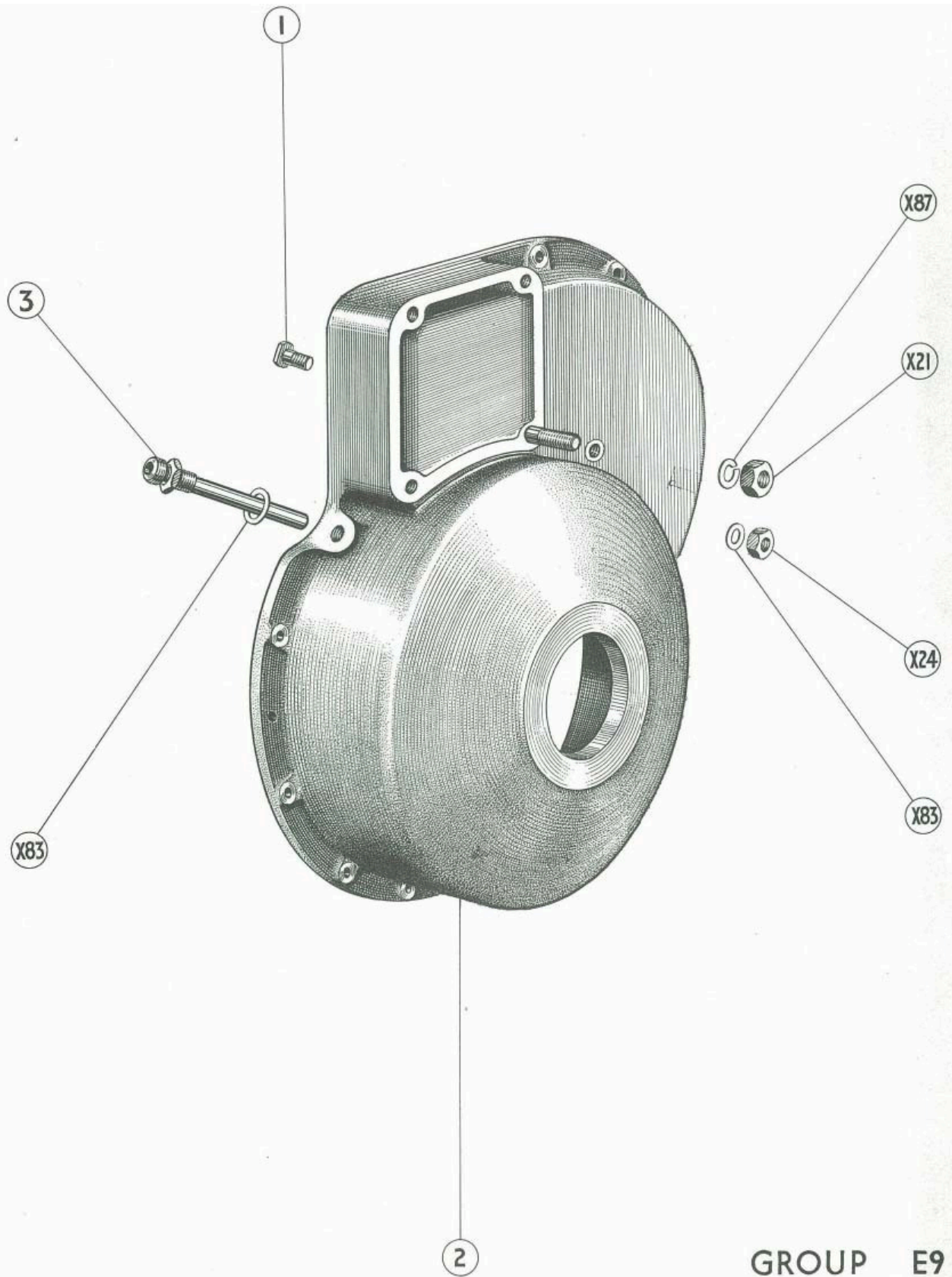

GROUP E9

