

BENTLEY MK VI

SECTION R

RADIATOR AND COOLING SYSTEM

		Containing:-
GROUP	1	CONNECTIONS
	2	FAN, PUMP AND THERMOSTAT
	3	RADIATOR
	4	SHELL

KEY TO CHASSIS NUMBERS

Used on	A, B, C, Series	
" " B-DA	2-190, 206, 220, 232, 238-268	= F
" " B-DA	192-204, 208-218, 222-230, 236, 270	= G
" " B-EW	251-263, 273 onwards	= H
" "	A, B, C, D, Series	
" " B-EY	All chassis	
" " B-EW	1-249, 265-271	= J
" "	A Series only	= K
" "	B Series onwards	= L
" "	A, B, C Series	
" " B-DA	All chassis	
" " B-DZ	1-235	= M
" " B-DZ	237 onwards	= N
" "	A, B, C, D, E, F Series	
" "	1-133, 141-205, 209-211	= O
" " B-GT	135-139, 207, 213 onwards	= P
" "	A Series	
" " B-BH	2-68	= Q
" " B-BH	70 onwards	= R
" " B-DA	192-204, 208-218, 222-230, 236, 270 to end of DA	
" " B-DZ	All chassis	
" "	E, F Series	
" " B-GT	1-133, 14-205, 209-211	= S

continued overleaf.

Used on	B-GT	135-139, 207, 213 to end H,J,K,L,M,N Series	
" "	B-PV	All chassis	
" "	B-PU	1-269, 303 to end	
" "	B-RT	2-48, 52-58, 66, 122 to end	
" "	B-RS	9	= T
" "	B-PU	271-301	
" "	B-RT	50, 60-64, 68-120	
" "	B-RS	1-7, 11 onwards	= U
" "	B-BH	70 onwards	
" "	B-BG	All chassis	
" "	B-BG	All C Series	
" "	B-DA	All chassis	
" "	B-DZ	1-51, 87-93	= V
" "	B-DZ	53-85, 95-271, 319-341, 369-377	= W
" "	B-DZ	273-317, 343-367, 379 onwards	= X
" "	B-DZ	53-85, 95 onwards to end of DZ	
" "	B-DZ	E, F Series	
" "	B-GT	1-133, 141-205, 209-211	= Y

GROUP R.1 CONNECTION.

Comprising:

BOLT, 2 BA. long, hose clip to frame	X.9	K.130/Z	1	
BOLT, 2 BA, short, hose clip to frame	X.9	KA.102/Z	1	
BOLT, .250 dia. hose clip to frame	X.10	KA.203/Z	2	
BOLT, 2 BA. clip hose to valance plate	X.9	KA.102/Z	1	
CLIP, double, heater feed & return hoses	1	RE.4743	2	
CLIP, heater, pipe to dashboard	2	RE.8974	2	H
CLIP, Jubilee, No.00	3	RE.9418	4	J
CLIP, Jubilee, No.00		RE.9418	6	H
CLIP, Jubilee, No.1A. by-pass hose	4	RE.4608	2	
CLIP, Jubilee, No.2A radiator hose	5	RE.4907	8	
CLIP, long, heater feed pipe	6	RE.4745	1	J
CLIP, short, heater return pipe	7	RE.4746	1	K
CLIP, short, heater return pipe	7	RE.6231	1	L
CLIP, single, heater return hose	8	RE.4744	2	J
CLIP, single, heater return hose		RE.4744	3	H
CLIP, thermometer pipe to induction pipe	9	RD.3508	4	
CLIP, thermometer pipe to dashboard	10	RF.3291	2	J
CLIP, thermometer pipe to dashboard		RF.3291	1	H
HEATER, car underseat type, assembly		RD.3283	1	M
HEATER, car underseat type, assembly	11	RD.6924	1	N
HOSE, rubber, by-pass connection	12	EB.5015	1	O
HOSE, rubber, by-pass connection		RE.12659	1	P
HOSE, rubber, car heater to pump pipe		RE.4741	1	Q
HOSE, rubber, car heater to pump pipe	13	RE.5748	1	R
HOSE, rubber, cylinder head to dashboard	14	RE.8986	1	H
HOSE, rubber, pump to car heater pipe	15	RE.4742	1	
HOSE, Rubber, radiator pipe	16	RE.3589	4	
NUT, half, 2 BA. hose clip to frame bolt and valance plate bolt when fitted	X.24	K.4307/Z	3	
NUT, half, .250 dia. hose clip to frame	X.24	K.4310/Z	2	
NUT, union		RE.3593	1	Q
PIECE, distance, heater pipe shield	16A	RE.10421	1	H
PIPE, bottom connection, to take drain pipe	17	RE.3587	1	F
PIPE, bottom connection	1	RE.4773	1	S
PIPE, bottom connection		RE.11271	1	T
PIPE, bottom connection		RE.18218	1	U
PIPE, cylinder head to hotspot	18	RE.3596	1	
PIPE, cylinder head to hotspot (when oil bath air cleaner is fitted)		RE.11312	1	
PIPE, heater, cylinder head	19	RE.8955	1	H
PIPE, cylinder head to dash	20	RE.8981	1	H
PIPE, cylinder head to dash	21	RE.5766	1	J
PIPE, cylinder head to dash (when oil bath air cleaner is fitted)		RE.9012	1	J
PIPE, hotspot to pump, return, assembly (RC)	22	RE.3594	1	O
PIPE, notspot to pump, return, assembly (RC)		RE.11290	1	P
PIPE, hotspot to pump, return assembly (LC)		RE.4315	1	O
PIPE, hotspot to pump, return assembly (LC)		RE.12285	1	P

Group R1 (Continued overleaf)

GROUP R.1 CONNECTIONS. (Continued)

PIPE, return, car heater to pump with nipple		RE.4739	1	Q
PIPE, return, car heater to pump, assembly, including -	23	RE.6233	1	V
Nut, union		RE.3593	1	
Tap, drain		RE.5747	1	
Washer, drain tap		KB.1096	1	
PIPE, return, car heater to pump, assembly as above except pipe		RE.8765	1	W
PIPE, return, car heater to pump, assembly as above except pipe		RE.7353	1	X
PIPE, top connection	24	RE.3588	1	
PLATE, dashboard seal	25	DB.1832	1	
SCREW, set, .250 dia., clip, pipe to clutch Casing (where fitted)	X.55	KC.904/Z	1	
SHIELD, dashboard rubber	26	DB.1830		
SHIELD, heater pipe	26A	RE.10423	1	H
TAP, drain, radiator, bottom pipe	27	RE.3789	1	F
WASHER, aluminium, drain tap	28	RE.3586	1	F
WASHER, spring, 2 BA, clip bolts	X.87	K.9006/Z	3	
WASHER, spring, .250 dia. clip bolts and screw	X.87	K.9008/Z	3	

GROUP R.2 WATER PUMP & FAN

Comprising:

ADAPTOR, fan flange to pulley		RE.4737	1	O
ADAPTOR, fan flange to pulley	1	RE.11272	1	P
ADAPTOR, fan flange to pulley		RE.19077	1	*
BELT, fan and pump driving	2	EB.4202	1	O
BELT, fan and pump driving		RE.4534	1	P
BOLT, .250" dia. backing plate to casing	X.10	K.213/Z	4	
CASING, pump		RE.3635	1	Q/V
CASING, pump		RE.4757	1	Y
CASING, pump	3	RE.11269	1	P
CASING, thermostat	4	RE.3598	1	
CONNECTION, water outlet	5	RE.3625	1	
FAN, cooling, assembly		RE.4758	1	O
FAN, cooling, assembly	6	RE.6060	1	P
FAN, cooling, assembly		RE.19078	1	*
HOUSING, rubber seal	7	RE.6870	1	
JOINT, backing plate	8	EB.4204	1	
JOINT, thermostat	9	EB.4004	1	
JOINT, water outlet connection to thermostat	10	EB.3952	1	
NUT, half .250 dia. backing plate to casing	X.24	K.4310/Z	4	
PLATE, backing	11	RE.5771	1	
PULLEY, fan and pump driving, high speed		RE.4736	1	O
PULLEY, fan and pump driving, low speed	13	RE.11270	1	P
PULLEY, fan and pump driving, high speed		RE.19043	1	*
PUMP, coolant assembly complete		RE.2602/A	1	Q/V
PUMP, coolant assembly complete		RE.12969	1	Y
PUMP, coolant assembly complete		RE.12970	1	P

Group R.2 (Continued overleaf)

GROUP R.2 WATER PUMP AND FAN (Continued)

RING, carbon gland, used with RE.6255 rotor		RE.6256	1	
RING, carbon gland, used with RE.12280 rotor	14	RE.12281	1	
RING, rubber seal, retaining	15	RE.2107	1	
RING, spring, rotor gland	16	RE.6869	1	
RING, spring, spindle housing bearing	17	RE.2025	1	
ROTOR, pump .100" x .4375" carbon gland slots		RE.6255	1	
ROTOR, pump .213" x .4375" carbon gland slots	18	RE.12280	1	
SCREW, countersunk head, 2BA adaptor pulley	X.50	K.2804/Z	4	0
SCREW, countersunk head, 2BA adaptor to pulley	X.50	K.2813/Z	4	*
SCREW, set, hex, head, fan to pulley	19	RE.4738	4	*
SCREW, set, hex, head fan blade		KC.298/Z	4	*
SCREW, hex, head, .250" dia. water outlet connection	X.55	KC.231/Z	4	
SCREW, locating thermostat	20	EB.3655	1	
SEAL, rubber, rotor gland	21	RE.7000	1	
SPINDLE, assembly, consisting of,	22	RE.3366	1	
Flinger		RE.2019	1	
Spindle, and bearing assembly		RE.11494	1	A
Spindle, and bearing assembly		RE.2018	1	A
Spindle, and bearing assembly		RE.13717	1	A
SPRING, gland	23	RE.2024	1	
TAP, heater return pipe	25	RE.5150	1	Q
TAP, heater return pipe	24	RE.7348	1	X
THERMOSTAT, unit	29	RE.11528	1	
UNION, heater return pipe	26	RE.6030	1	V/W
UNION, hotspot	27	EB.5133	1	
UNION, thermometer	28	RE.3391	1	
WASHER, aluminium .625" dia. outlet union	X.83	KB.1081	1	
WASHER, aluminium, car heater union	X.83	KB.1098	1	V/W
WASHER, aluminium, thermostat locating screw	30	RE.3658	1	
WASHER, C & A tap	31	RE.4787	1	Q/X
WASHER, spring, .250" dia. backing plate to casing bolt	X.87	K.9008/Z	4	
WASHER, spring, .312" dia. fan to pulley	X.87	K.9009/Z	4	
WASHER, spring, .250" dia. thermostat outlet connection	X.87	K.9008/Z	4	
WASHER, union thermometer	X.83	KB.1092	1	

NOTE. * Used on cars exported to Switzerland

GROUP R.3 RADIATOR.

Comprising:-

BOLT, .250" dia. horn mounting bracket	X.10	K.203/Z	4	
BOLT, .250" dia. steam pipe to yoke clip		KA.202/Z	1	
BOLT, radiator mounting	1	RE.1311	1	
BRACKET, shell to yoke L.H.	22	RE.3706	1	
BRACKET, shell to yoke R.H.	3	RE.3705	1	
BRACKET, horn mounting L.H.	4	RE.7399	1	
BRACKET, horn mounting R.H.	5	RE.7400	1	
CAP, filler	6	RE.11320	1	

GROUP R.3 (Continued overleaf)

GROUP R.3. RADIATOR (Continued)

CLIP, steam pipe to yoke	7	RE.3599	1	
NUT, half, .250" dia. steam pipe clip (1)				
yoke stiffener (6) horn bracket (4)	X.24	K.4310/Z	11	
PIPE, drain tap (used with 19 x 23" matrix)		RE.3845	1	
RADIATOR, assembly complete, with shell and shutters (19 x 21" x 58 mm matrix)		RE.3701	1	F
RADIATOR, assembly complete with shell and shutters (19 x 23" x 58 mm matrix)		RE.7548	1	Q G
RADIATOR, assembly complete, with shell and shutters (19 x 23" x 58 mm. matrix)		RE.13739	1	*
RADIATOR, assembly, top and bottom tanks and top cradle (19 x 21" matrix) with		RE.3691	1	F
Cradle assembly		RE.3690	1	
Screw, set .250" dia. cradle to tank		K.2007/Z	1	
Valve, steam escape, assembly		RE.7869	1	
Body, valve		EB.1890	1	
Plug, valve body		KB.1063	1	
Spring, anti-spill valve		EW.1894	1	
Valve,		RE.7868	1	
Washer, valve body		KB.1081	1	
Washer, .250" top tank to cradle		K.9008/Z	1	
RADIATOR, assembly, top & bottom tanks & top cradle as above except matrix (19 x 23")	8	RE.13737	1	G
SCREW, hex head .250" dia. shell to yoke brackets front	X.55	KC.201/Z	2	
SCREW, hex. head, .250" dia. shell to yoke brackets rear outer	A.55	KC.203/Z	2	
SCREW, hex. head. .250" dia. shell to yoke brackets and apron	X.55	KC.907	2	
SCREW, hex. head .250" dia. yoke stiffener	X.55	KC.902	6	
STIFFENER, diagonal, front and rear	9	RE.3648	2	
STIFFENER, horizontal, rear	10	RE.3620	1	
TAP, drain (used with 19 x 23" matrix)	11	RE.3850	1	G
WASHER, drain tap (used with 19 x 23" matrix)	12	RE.9233	1	G
WASHER, plain, shell to yoke bracket, .125" thick RE.4790, .175" thick RE.4789	13			
WASHER, rubber, filler cap	14	EW.1666	1	
WASHER, spring, .250" dia. shell to yoke bracket (6) steam pipe clip (1) stiffener (6) horn bracket (4)	X.87	K.9008/Z	17	
WASHER, spring, .500" dia. radiator mounting	X.87	K.9012/Z	1	
WEDGE, radiator to yoke	15	EW.1952	2	
YOKE, radiator mounting assembly to suit 19 x 21" matrix		RE.3668	1	F
YOKE, radiator mounting, assembly to suit 19 x 23" matrix (high wing)		RE.7547	1	Q G
YOKE, radiator mounting, assembly to suit 19 x 23" matrix (lowered wing)	16	RE.8549	1	*

NOTE:- Q Used when high type wing is fitted. In this case the least distance between the top of the wing arch and the top of the bonnet side plate is not greater than $\frac{5}{8}$ ".

Group, R.3 (Continued overleaf)

GROUP R.3 RADIATOR. (Continued)

* Used when lowered front wing is fitted. In this case the least distance between the top of the wing arch and the top of the bonnet side plate is one inch.

GROUP R.4 SHELL & SHUTTERS.

Comprising:

CAP, mascot	1	EB.3601	1	
CAP, no mascot type		RE.9338	1	
EYE, bonnet hinge	2	RE.3849	1	
GUIDE, mascot spring	3	E.87327	1	
MASCOT, assembly, with 1 off stud RE.9072	4	EB.2683	1	
NUT, half, 5 BA. bonnet rest tape screw	X.24	K.4301/Z	8	
NUT, half, .250 dia. bonnet eye		K.4310/Z	2	
NUT, mascot	5	E.7700	1	
PIN, split mascot	6	E.84689	1	
SCREW, cheese-head, 5 BA. bonnet rest tape	7	RE.9342	8	
SCREW, countersunk head, top bearing strip	8	RE.8526	4	
SCREW, countersunk head, .250 dia. bonnet eye	X.51	K.2904/Z	2	
SHELL, & shutter assy., to suit 19 x 21" matrix complete with,		RE.4622A	1	⊙
Badge		EB.1157	1	
Nut, shutter to shell		K.4310/Z	4	
Shell		RE.4613	1	
Shutter assembly		RE.4622	1	
SHELL, & shutter assembly to suit 19 x 23" matrix as above except,	9	RE.9614	1	*
shell		RE.7559	1	
Shutter assembly		RE.1804C	1	
SPRING, bronze, mascot	10	E.81349	1	
TAPE, bonnet rest	11	RE.9344	2	
WASHER, bakelite, mascot	12	RE.5847	1	
WASHER, leather, valance to shell	13	RE.9757	4	
WASHER, plain, valance to shell		CS.6504/Z	4	
WASHER, plain, 5 BA bonnet rest tape	X.85	K.4401/Z	8	
WASHER, spring 5 BA bonnet rest tape	X.87	K.9003/Z	8	
WASHER, spring 5 BA valance to shell		CS.6708/Z	4	
WASHER, spring, .250 dia. bonnet eye		K.9008/Z	2	
WIRE, locking mascot stud		RE.3714	1	

NOTE: ⊙ See Group R.3
* See Group R.3

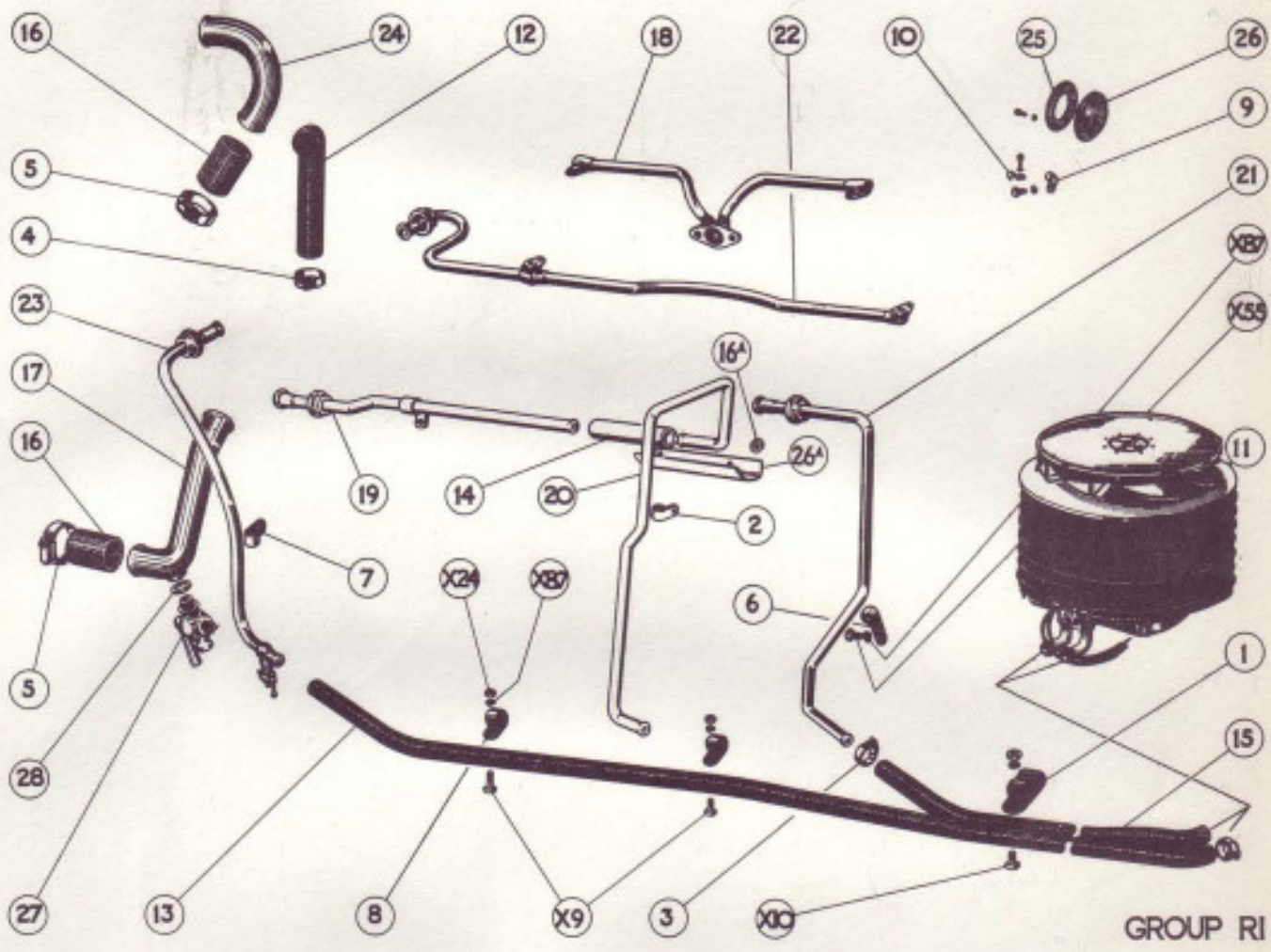

GROUP RI



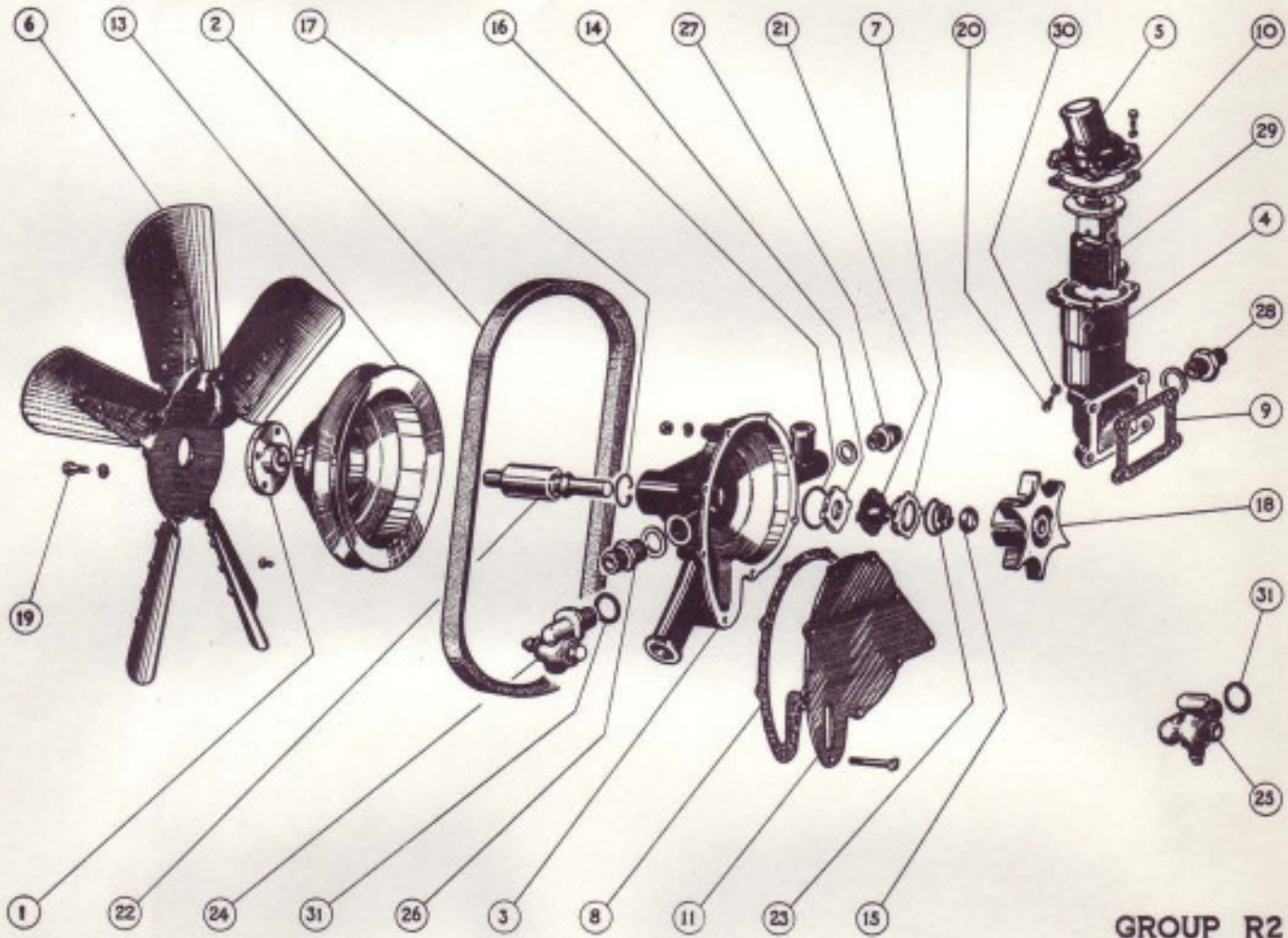

GROUP R2



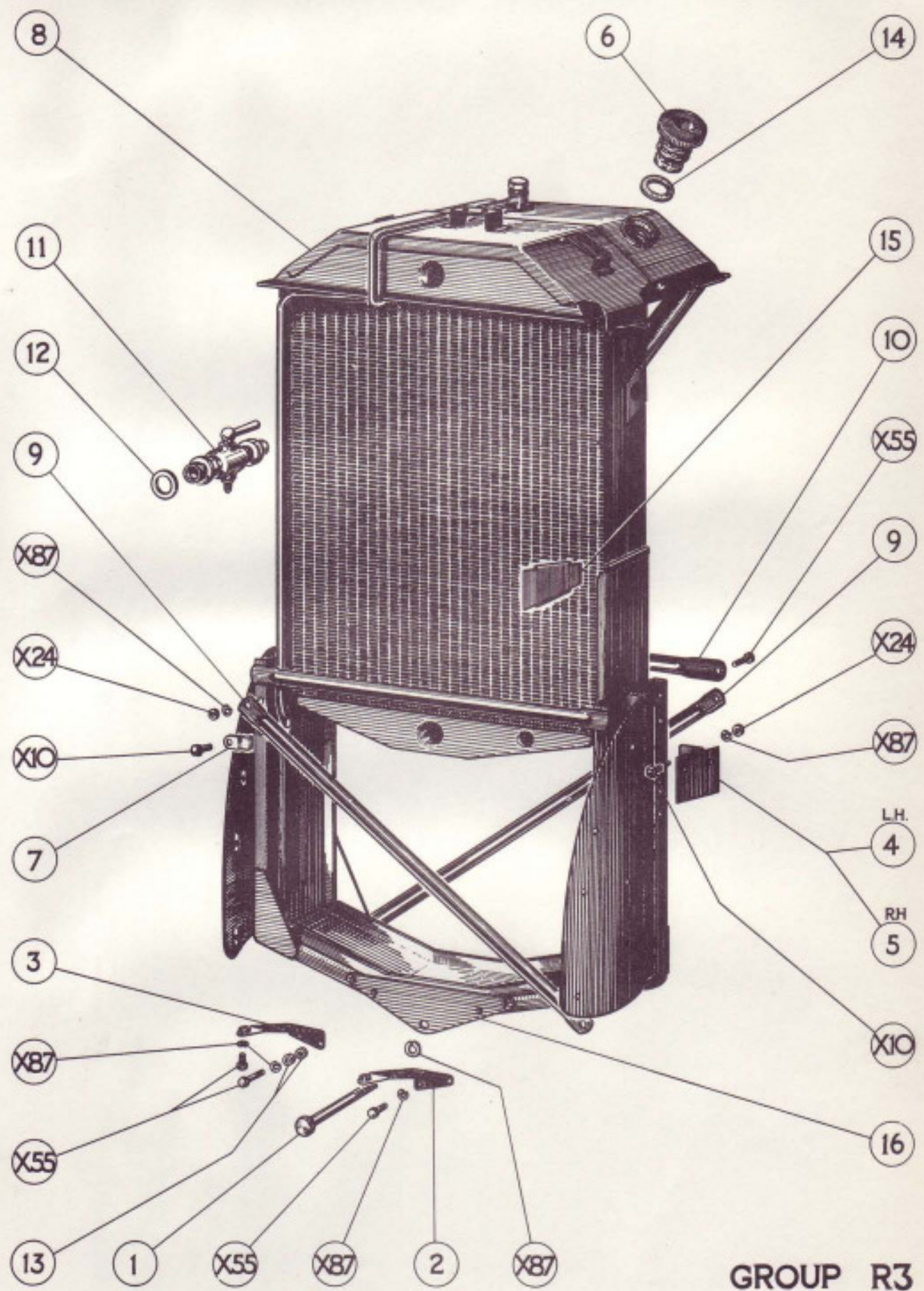

GROUP R3



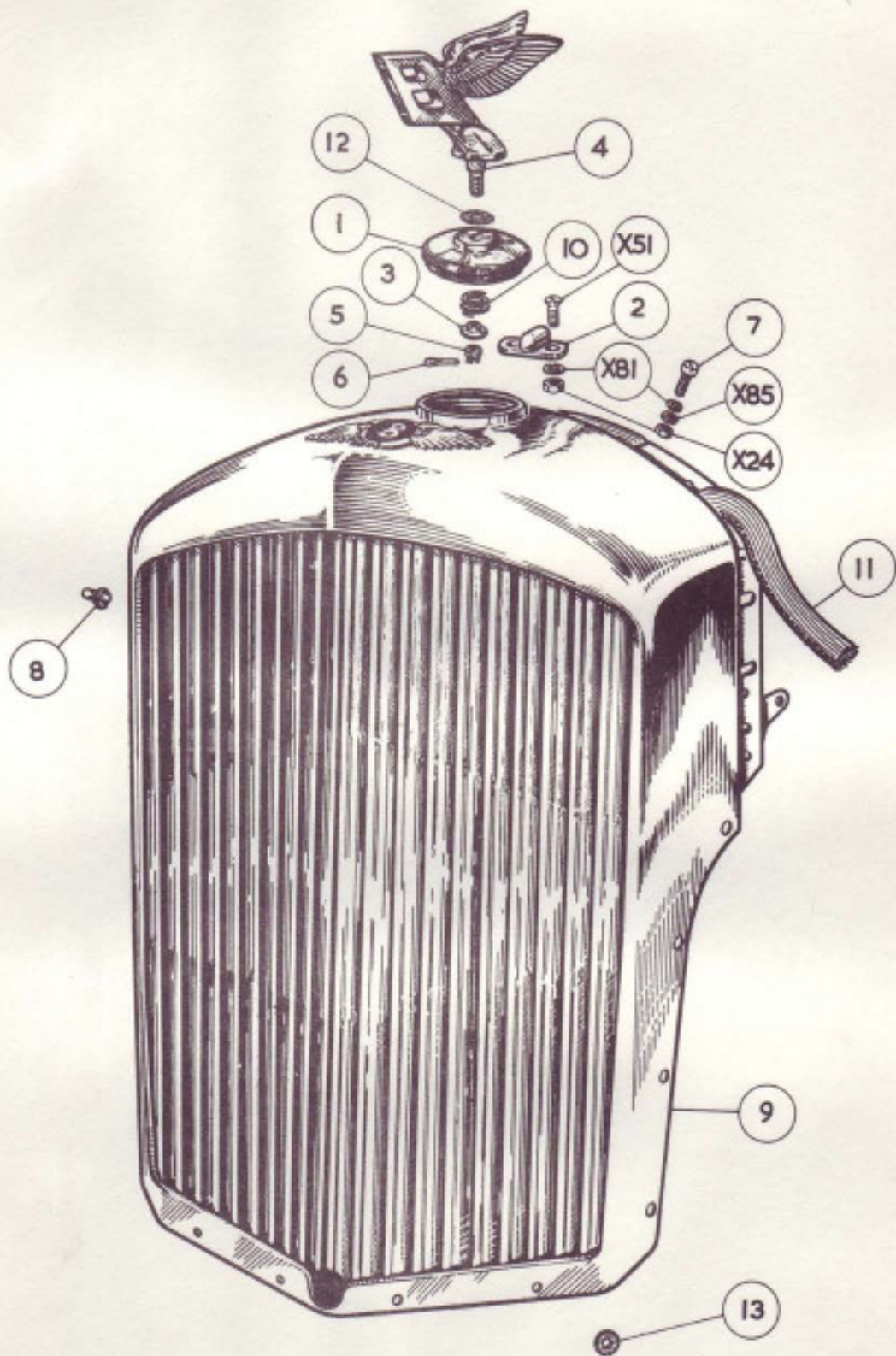

GROUP R4

